

1/2" - 1" FITTING
MULTIPLIER (**HLSD**):

1-1/4" AND ABOVE FITTING
MULTIPLIER (**HLLD**):

ACCESORIES & TOOLS
MULTIPLIER (**HLT**):

Heat Link[®]

Plumbing, Heating, & Panels
Product Catalog / Price List

EFFECTIVE: APRIL 18, 2022

2022 | USA

CRIMP PRESS & EXPANSION SYSTEMS

AVAILABLE THROUGH
SUNBELT
MARKETING

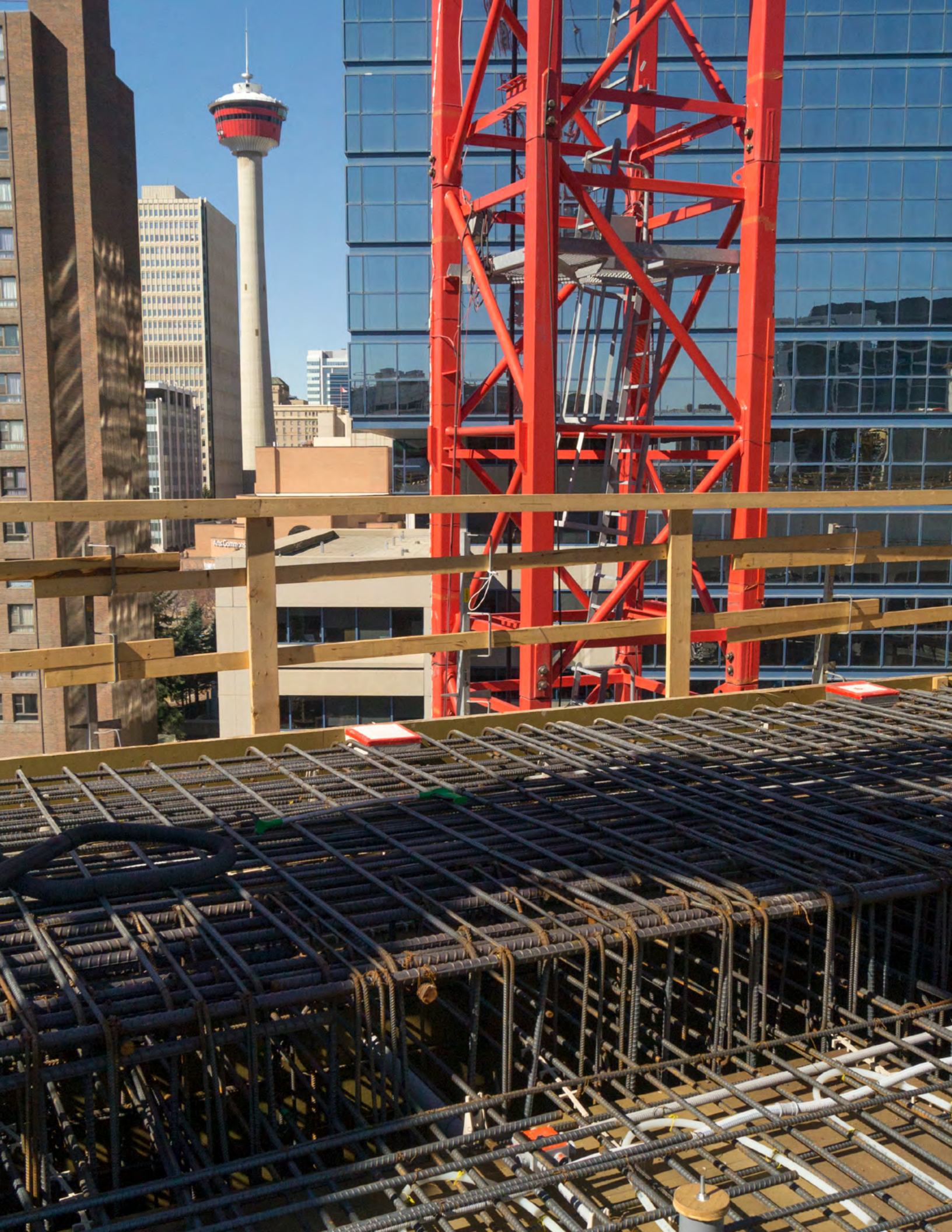



About Us

HeatLink Group Inc. is a multi-system supplier of potable water and radiant hydronic heating/cooling and snow melt systems. For over 25 years we have created comfortable and efficient heating, cooling and plumbing systems for residential and commercial construction.

HeatLink's radiant heating systems create a comfortable and energy efficient environment for living. Our snow melt systems create safer public and private spaces that reduce liability for property owners, reduce maintenance, and ensure accessibility. Our well engineered plumbing systems provide peace of mind for property owners through extensive warranty protection, and enable quick and efficient installations for builders and contractors.

History

HeatLink began as a family owned business developed to service a number of industries including HVAC. The company grew to meet the needs of builders, contractors, and architects and began designing and installing radiant heating systems in 1985. Since 1985 HeatLink has grown into an industry leading designer and manufacturer of radiant heating, cooling, and potable water systems.

HeatLink has developed and manufactured a long list of industry firsts such as the "TwistSeal" tool-less manifold in 1996. The company began manufacturing PEX-a tubing in 1998 and now supplies the highest quality PEX-a systems to customers throughout North America and parts of Europe and Asia.

HeatLink was acquired by Mueller Industries in 2017. Mueller is a publicly traded manufacturer headquartered in Collierville, Tennessee that began operating in 1917 and has operations across the USA, Canada, Mexico, Great Britain, South Korea, the Middle East, and China.

HeatLink works with a network of experienced and successful partner agencies to meet the design, system installation and training needs of the construction industry, designers, and architects.

Solutions

HeatLink is an industry leader in providing a broad range of potable water and radiant heating/cooling and snow melt systems for customers throughout the world. Our focus from our inception remains on creating well engineered and energy efficient solutions that are easy to install and last a lifetime.

Company Description

Our innovative plumbing and heating systems help provide a comfortable and worry free environment for people in residential and commercial work and living spaces. We continue to design quiet and energy efficient heating and potable water systems that are easy to install and last a lifetime. HeatLink was built on a strong family work ethic and a value system that remain the foundation for our continuing growth and industry leadership role.

Parent Company Description

Mueller Industries, Inc. is a leading industrial manufacturer that specializes in copper and copper alloy manufacturing while also producing goods made from aluminum, steel, and plastics. The range of these products is broad: copper tube and fittings; line sets; brass and copper alloy rod, bar, and shapes; aluminum and brass forgings; aluminum impact extrusions; PEX plastic tube; refrigeration valves and fittings; fabricated tubular products; and steel nipples. Mueller also resells brass and plastic plumbing valves, plastic fittings, malleable iron fittings, faucets and plumbing specialty products. Mueller products can be found as critical components in applications ranging from potable water distribution to automotive drive trains to household appliances to radar defense systems, and more, quietly doing their part to make life and business better.

Making a Lasting Impression

Press Sleeve

HeatLink Potable Water Systems now offers a start-to-finish system capped off with the unique PEX tubing watertight connection ... the stainless steel Press Sleeve.

The Press Sleeve slides over the outer part of the PEX-a tubing, before inserting the fitting. When the fitting is in place, the press tool secures the connection in one single press, evidenced by a smooth visible depression ring on the sleeve's surface.

Once the pressing is complete, everything is set for the pressure test. The room for error is reduced, as the visible impression on the sleeve indicates readiness for the pressure test.

HeatLink's Press Sleeve—an impressive connection to have in any pressing situation.

The SS Press Sleeve is tested to ASTM F877 and is NSF-pw listed.



non-pressed



pressed
(press profile may vary with tool)



Stainless Steel Press Sleeves 24200 Series

Press sleeve with view hole.

For complete specifications, see submittal [SUB24200](#).

Stk#	Description	Pkg Qty	Carton Qty	Unit	List Price / Unit
24205	½" SS Press Sleeve	100	1000	ea.	\$ 0.568
24222	¾" SS Press Sleeve	50	500	ea.	\$ 0.893
24228	1" SS Press Sleeve	50	250	ea.	\$ 1.831
24235	1-¼" SS Press Sleeve	10	150	ea.	\$ 7.280
24241	1-½" SS Press Sleeve	10	100	ea.	\$ 8.652
24250	2" SS Press Sleeve	10	100	ea.	\$ 10.511



13203M

Closed End HPP Mini Multiport Tee 13000M Series

Closed one end and ¾" PEX insert on the other end. ½" branches in single row. SS press sleeves sold separately.

For complete specifications, see submittal [SUB13000M](#).

Stk#	Description	Pkg Qty	Carton Qty	Unit	List Price / Unit
13202M	2 Port, ¾" PEX × Closed End HPP Mini Multiport Tee	5	100	ea.	\$ 9.853
13203M	3 Port, ¾" PEX × Closed End HPP Mini Multiport Tee	5	80	ea.	\$ 13.093
13204M	4 Port, ¾" PEX × Closed End HPP Mini Multiport Tee	5	60	ea.	\$ 16.653



13203



13833

Closed End HPP Multiport Tee 13000 Series

Closed one end and ¾" or 1" PEX insert on the other end. ½" branches in single row or opposing rows. SS press sleeves sold separately.

For complete specifications, see submittal [SUB13000](#).

	Stk#	Description	Pkg Qty	Carton Qty	Unit	List Price / Unit
WSL	13203	3 Port Single Row, ¾" PEX × Closed End HPP Multiport Tee	5	250	ea.	\$ 40.251
	13204	4 Port Single Row, ¾" PEX × Closed End HPP Multiport Tee	5	250	ea.	\$ 35.836
	13206	6 Port Single Row, ¾" PEX × Closed End HPP Multiport Tee	5	150	ea.	\$ 42.779
	13208	8 Port Single Row, ¾" PEX × Closed End HPP Multiport Tee	5	125	ea.	\$ 70.335
WSL	13806	6 Port Single Row, 1" PEX × Closed End HPP Multiport Tee	5	150	ea.	\$ 49.112
WSL	13808	8 Port Single Row, 1" PEX × Closed End HPP Multiport Tee	5	125	ea.	\$ 62.220
WSL	13833	6 Port Opposing Rows, 1" PEX × Closed End HPP Multiport Tee	5	250	ea.	\$ 38.290
WSL	13844	8 Port Opposing Rows, 1" PEX × Closed End HPP Multiport Tee	5	250	ea.	\$ 44.030



14203M

Flow Through HPP Mini Multiport Tee 14000M Series

Open on both ends with ¾" PEX insert connections. ½" branches in single row. SS press sleeves sold separately.

For complete specifications, see submittal [SUB14000M](#).

Stk#	Description	Pkg Qty	Carton Qty	Unit	List Price / Unit
14202M	2 Port, ¾" PEX × ¾" PEX Flow Through HPP Mini Multiport Tee	5	100	ea.	\$ 10.444
14203M	3 Port, ¾" PEX × ¾" PEX Flow Through HPP Mini Multiport Tee	5	80	ea.	\$ 13.762
14204M	4 Port, ¾" PEX × ¾" PEX Flow Through HPP Mini Multiport Tee	5	60	ea.	\$ 17.203



14203



14233

Flow Through HPP Multiport Tee 14000 Series

Open on both ends with ¾" or 1" PEX insert connections. ½" branches in single row or opposing rows. SS press sleeves sold separately.

For complete specifications, see submittal [SUB14000](#).

	Stk#	Description	Pkg Qty	Carton Qty	Unit	List Price / Unit
WSL	14203	3 Port Single Row, ¾" PEX × ¾" PEX Flow Through HPP Multiport Tee	5	250	ea.	\$ 29.767
WSL	14204	4 Port Single Row, ¾" PEX × ¾" PEX Flow Through HPP Multiport Tee	5	200	ea.	\$ 31.294
WSL	14703	3 Port Single Row, 1" PEX × ¾" PEX Flow Through HPP Multiport Tee	5	200	ea.	\$ 27.250
WSL	14704	4 Port Single Row, 1" PEX × ¾" PEX Flow Through HPP Multiport Tee	5	200	ea.	\$ 36.010
WSL	14706	6 Port Single Row, 1" PEX × ¾" PEX Flow Through HPP Multiport Tee	5	100	ea.	\$ 60.468
WSL	14708	8 Port Single Row, 1" PEX × ¾" PEX Flow Through HPP Multiport Tee	5	150	ea.	\$ 60.073
WSL	14233	6 Port Opposing Rows, ¾" PEX × ¾" PEX Flow Through HPP Multiport Tee	5	200	ea.	\$ 39.023
WSL	14244	8 Port Opposing Rows, ¾" PEX × ¾" PEX Flow Through HPP Multiport Tee	5	125	ea.	\$ 44.030
WSL	14733	6 Port Opposing Rows, 1" PEX × ¾" PEX Flow Through HPP Multiport Tee	5	150	ea.	\$ 38.290
WSL	14744	8 Port Opposing Rows, 1" PEX × ¾" PEX Flow Through HPP Multiport Tee	5	100	ea.	\$ 44.030

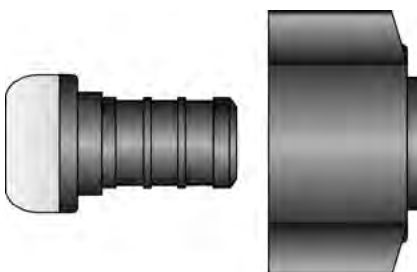
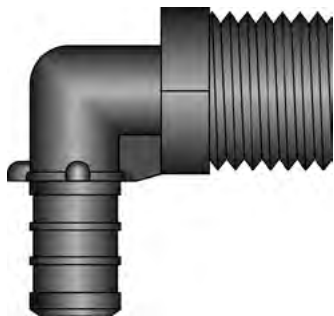
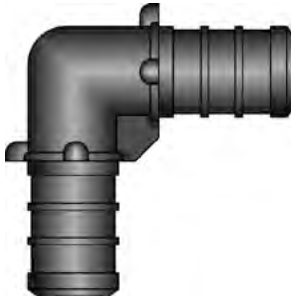
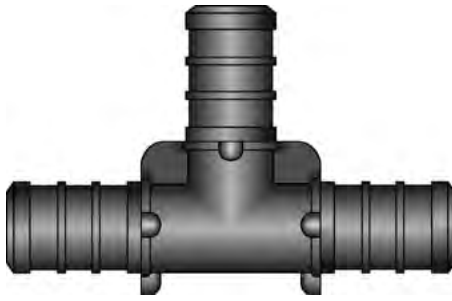

Heat Link[®]

HPP Fitting System

The HeatLink High Performance Polymer (HPP) fitting system is produced from a specific blend of engineered high performance polyphenylsulfone (PPSU) resins. When combined, these resins offer outstanding long-term performance and chemical resistance. The sulfone family of resins began to replace brass in the plumbing industry over 20 years ago, and in the course of time have exceeded the stringent demands of the potable and heating industries.

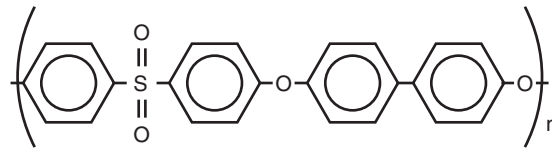
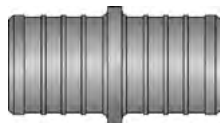

Figure #1 – General Chemical Structure of PPSU

The HeatLink HPP fittings stand out in the market place due to a unique combination of characteristics designed to deliver superior performance.

- Outstanding resistance to hot chlorinated water
- Superior long-term hydrostatic strength
- Excellent thermal stability
- High resistance to mineral acids, alkali, and salt solutions
- Higher resistance to polar solvents and stress cracking than traditional polysulfone
- Robust toughness and impact strength
- Exceptional hydrolytic stability
- Improved notch resistance





PEX Insert Couplings - **No Lead Brass** 29000NL Series

Solid no lead brass (C69300-EcoBrass) PEX insert × PEX insert couplings. SS press sleeves sold separately.

For complete specifications, see submittal [SUB29000NL](#).

Stk#	Description	Pkg Qty	Carton Qty	Unit	List Price / Unit
29005NL	½" × ½" PEX No Lead Brass Coupling	25	500	ea.	\$ 3.112
29022NL	¾" × ¾" PEX No Lead Brass Coupling	25	250	ea.	\$ 4.070
29028NL	1" × 1" PEX No Lead Brass Coupling	10	250	ea.	\$ 6.639
29035NL	1-¼" × 1-¼" PEX No Lead Brass Coupling	5	180	ea.	\$ 13.750
29041NL	1-½" × 1-½" PEX No Lead Brass Coupling	5	90	ea.	\$ 47.011
29054NL	2" × 2" PEX No Lead Brass Coupling	5	25	ea.	\$ 67.882

Note: 1-½" and larger fittings may be ordered in less than package quantities; no surcharge.

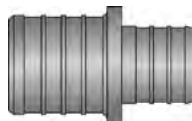

PEX Insert Reducing Couplings - **No Lead Brass** 29200NL Series

Solid no lead brass (C69300-EcoBrass) PEX insert × PEX insert reducing couplings. SS press sleeves sold separately.

For complete specifications, see submittal [SUB29000NL](#).

Stk#	Description	Pkg Qty	Carton Qty	Unit	List Price / Unit
29225NL	¾" × ½" PEX No Lead Brass Coupling	25	500	ea.	\$ 5.470
29282NL	1" × ¾" PEX No Lead Brass Coupling	10	250	ea.	\$ 7.395
29238NL	1-¼" × 1" PEX No Lead Brass Coupling	5	200	ea.	\$ 14.433
29243NL	1-½" × 1-¼" PEX No Lead Brass Coupling	5	100	ea.	\$ 24.777
29248NL	1-½" × 1" PEX No Lead Brass Coupling	5	100	ea.	\$ 45.677
29263NL	2" × 1-¼" PEX No Lead Brass Coupling	5	25	ea.	\$ 62.992
29264NL	2" × 1-½" PEX No Lead Brass Coupling	5	25	ea.	\$ 66.364

Note: 1-½" and larger fittings may be ordered in less than package quantities; no surcharge.

PEX Insert Couplings - *HPP*
19000 Series

High Performance Polymer PEX insert couplings. SS press sleeves sold separately.

For complete specifications, see submittal [SUB19000](#).

Stk#	Description	Pkg Qty	Carton Qty	Unit	List Price / Unit
19005	½" × ½" PEX HPP Coupling	25	1000	ea.	\$ 1.250
19022	¾" × ¾" PEX HPP Coupling	25	500	ea.	\$ 1.910
19028	1" × 1" PEX HPP Coupling	10	200	ea.	\$ 3.711

PEX Insert Reducing Couplings - *HPP*
19200 Series

High Performance Polymer PEX insert reducing couplings. SS press sleeves sold separately.

For complete specifications, see submittal [SUB19000](#).

Stk#	Description	Pkg Qty	Carton Qty	Unit	List Price / Unit
19225	¾" × ½" PEX HPP Coupling	25	600	ea.	\$ 1.533
19282	1" × ¾" PEX HPP Coupling	5	300	ea.	\$ 3.629

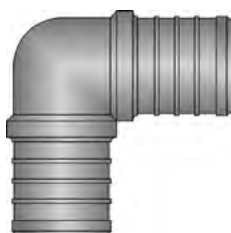

PEX Insert Elbows - **No Lead Brass** **28000NL Series**

Solid no lead brass (C69300-EcoBrass) PEX insert × PEX insert elbows. SS press sleeves sold separately.

For complete specifications, see submittal [SUB28000NL](#).

Stk#	Description	Pkg Qty	Carton Qty	Unit	List Price / Unit
28005NL	½" × ½" PEX No Lead Brass Elbow	25	250	ea.	\$ 4.325
28022NL	¾" × ¾" PEX No Lead Brass Elbow	25	250	ea.	\$ 6.456
28028NL	1" × 1" PEX No Lead Brass Elbow	10	100	ea.	\$ 14.584
28035NL	1-¼" × 1-¼" PEX No Lead Brass Elbow	5	120	ea.	\$ 27.256
28041NL	1-½" × 1-½" PEX No Lead Brass Elbow	5	50	ea.	\$ 65.857
28054NL	2" × 2" PEX No Lead Brass Elbow	5	25	ea.	\$ 114.041

Note: 1-½" and larger fittings may be ordered in less than package quantities; no surcharge.

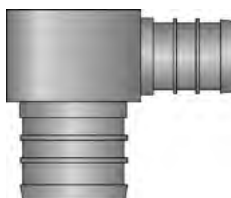

PEX Insert Reducing Elbows - **No Lead Brass** **28200NL Series**

Solid no lead brass (C69300-EcoBrass) PEX insert × PEX insert reducing elbows. SS press sleeves sold separately.

For complete specifications, see submittal [SUB28000NL](#).

WSL

Stk#	Description	Pkg Qty	Carton Qty	Unit	List Price / Unit
28225NL	¾" × ½" PEX No Lead Brass Elbow	10	250	ea.	\$ 5.280



PEX Insert Elbows - **HPP** **18000 Series**

High Performance Polymer PEX insert elbows. SS press sleeves sold separately.

For complete specifications, see submittal [SUB18000](#).

Stk#	Description	Pkg Qty	Carton Qty	Unit	List Price / Unit
18005	½" × ½" PEX HPP Elbow	25	600	ea.	\$ 1.574
18022	¾" × ¾" PEX HPP Elbow	25	300	ea.	\$ 2.678
18225	¾" × ½" PEX HPP Elbow	10	400	ea.	\$ 2.504
18028	1" × 1" PEX HPP Elbow	10	150	ea.	\$ 6.292

PEX Insert × MNPT Elbows - *No Lead Brass*
28500NL Series

Solid no lead brass (C69300-EcoBrass) PEX insert elbows. SS press sleeves sold separately.

For complete specifications, see submittal [SUB28500NL](#).

Stk#	Description	Pkg Qty	Carton Qty	Unit	List Price / Unit
28535NL	1-1/4" PEX × 1-1/4" MNPT No Lead Brass Elbow	5	50	ea.	\$ 58.990

Note: 1-1/2" and larger fittings may be ordered in less than package quantities; no surcharge.



PEX Insert × MNPT Adapters - **No Lead Brass** 27500NL Series

Solid brass no lead (C69300-EcoBrass) PEX insert × MNPT adapters. SS press sleeves sold separately.

For complete specifications, see submittal [SUB27500NL](#).

Stk#	Description	Pkg Qty	Carton Qty	Unit	List Price / Unit
27505NL	½" PEX × ½" MNPT No Lead Brass Adapter	25	250	ea.	\$ 7.370
27552NL	½" PEX × ¾" MNPT No Lead Brass Adapter	10	250	ea.	\$ 10.339
27522NL	¾" PEX × ¾" MNPT No Lead Brass Adapter	25	250	ea.	\$ 10.692
27525NL	¾" PEX × 1" MNPT No Lead Brass Adapter	25	250	ea.	\$ 8.731
27528NL	1" PEX × 1" MNPT No Lead Brass Adapter	10	150	ea.	\$ 19.061
27582NL	1" PEX × ¾" MNPT No Lead Brass Adapter	5	200	ea.	\$ 13.652
27535NL	1-¼" PEX × 1-¼" MNPT No Lead Brass Adapter	5	100	ea.	\$ 45.931
27538NL	1-¼" PEX × 1" MNPT No Lead Brass Adapter	5	100	ea.	\$ 30.316
27541NL	1-½" PEX × 1-½" MNPT No Lead Brass Adapter	5	50	ea.	\$ 47.808
27554NL	2" PEX × 2" MNPT No Lead Brass Adapter	5	25	ea.	\$ 134.250

Note: 1-½" and larger fittings may be ordered in less than package quantities; no surcharge.



PEX Insert × MNPT Adapters - **HPP** 17500 Series

High Performance Polymer PEX insert × MNPT adapters. SS press sleeves sold separately.

For complete specifications, see submittal [SUB17500](#).

Stk#	Description	Pkg Qty	Carton Qty	Unit	List Price / Unit
17505	½" PEX × ½" MNPT HPP Adapter	25	500	ea.	\$ 2.582
17552	½" PEX × ¾" MNPT HPP Adapter	25	350	ea.	\$ 3.239
17522	¾" PEX × ¾" MNPT HPP Adapter	25	300	ea.	\$ 3.362
17525	¾" PEX × 1" MNPT HPP Adapter	25	400	ea.	\$ 2.110

WSL



Drop Ear Elbows - **No Lead Brass** 28300NL Series

Solid no lead brass (C69300-EcoBrass) ½" PEX insert × ½" FNPT drop ear elbow. SS press sleeves sold separately.

For complete specifications, see submittal [SUB28300NL](#).

Stk#	Description	Pkg Qty	Carton Qty	Unit	List Price / Unit
28305NL	½" PEX × ½" FNPT Drop Ear No Lead Brass Elbow	10	160	ea.	\$ 17.836



PEX Insert × FNPT Adapters - **No Lead Brass** 27600NL Series

Solid no lead brass (C69300-EcoBrass) PEX insert × FNPT adapters. SS press sleeves sold separately.

For complete specifications, see submittal [SUB27600NL](#).

	Stk#	Description	Pkg Qty	Carton Qty	Unit	List Price / Unit
	27605NL	½" PEX × ½" FNPT No Lead Brass Adapter	25	400	ea.	\$ 8.909
	27622NL	¾" PEX × ¾" FNPT No Lead Brass Adapter	25	300	ea.	\$ 12.231
	27628NL	1" PEX × 1" FNPT No Lead Brass Adapter	25	150	ea.	\$ 16.886
WSL	27632NL	1-¼" PEX × ¾" FNPT No Lead Brass Adapter	5	200	ea.	\$ 21.890
	27635NL	1-¼" PEX × 1-¼" FNPT No Lead Brass Adapter	5	80	ea.	\$ 55.404
WSL	27638NL	1-¼" PEX × 1" FNPT No Lead Brass Adapter	5	100	ea.	\$ 29.670
WSL	27641NL	1-½" PEX × 1-½" FNPT No Lead Brass Adapter	5	50	ea.	\$ 72.000

Note: 1-½" and larger fittings may be ordered in less than package quantities; no surcharge.

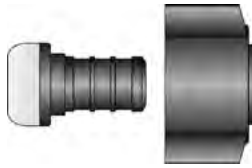

PEX Insert x FNPT Swivel Adapters - **HPP** 17700 Series

High Performance Polymer PEX insert x FNPT swivel adapters. SS press sleeves sold separately.

For complete specifications, see submittal [SUB17700](#).

WSL

Stk#	Description	Pkg Qty	Carton Qty	Unit	List Price / Unit
17755	1/2" PEX x 1/2" FNPT Swivel HPP Adapter	25	500	ea.	\$ 3.242
17705	1/2" PEX x Ballcock/Closet FNPT Swivel HPP Adapter	25	525	ea.	\$ 3.920



PEX Insert x FNPT Swivel Elbow Adapter - **HPP** Stk# 18605

High Performance Polymer PEX insert x FNPT swivel elbow adapters. SS press sleeves sold separately.

For complete specifications, see submittal [SUB18605](#).

WSL

Stk#	Description	Pkg Qty	Carton Qty	Unit	List Price / Unit
18605	1/2" PEX x 1/2" FNPT HPP Swivel Elbow	25	300	ea.	\$ 3.050



1/2" PEX x 3/8" O.D. Comp. Straight Lav. Tube Adapter - **NL** **Brass**

Stk# 25751NL

Solid no lead brass (C69300-EcoBrass) adapter for connecting faucets. SS press sleeves sold separately.

For complete specifications, see submittal [SUB25751NL](#).

Stk#	Description	Pkg Qty	Carton Qty	Unit	List Price / Unit
25751NL	1/2" PEX x 3/8" O.D. No Lead Brass Adapter	5	100	ea.	\$ 5.382



PEX Insert × Male Sweat Adapters - **No Lead Brass** 27100NL Series

Solid no lead brass (C69300-EcoBrass) PEX insert × male sweat adapters. SS press sleeves sold separately.

Not intended for use with copper press fittings.

For complete specifications, see submittal [SUB27000NL](#).

Stk#	Description	Pkg Qty	Carton Qty	Unit	List Price / Unit
27105NL	½" PEX × ½" M/Sweat No Lead Brass Adapter	25	700	ea.	\$ 3.538
27122NL	¾" PEX × ¾" M/Sweat No Lead Brass Adapter	25	400	ea.	\$ 6.380
27128NL	1" PEX × 1" M/Sweat No Lead Brass Adapter	10	200	ea.	\$ 11.708
27135NL	1-¼" PEX × 1-¼" M/Sweat No Lead Brass Adapter	5	120	ea.	\$ 22.080
27141NL	1-½" PEX × 1-½" M/Sweat No Lead Brass Adapter	5	80	ea.	\$ 73.052
27154NL	2" PEX × 2" M/Sweat No Lead Brass Adapter	5	25	ea.	\$ 86.723

Note: 1-½" and larger fittings may be ordered in less than package quantities; no surcharge.



PEX Insert × Female Sweat Adapters - **No Lead Brass** 27200NL & 27300NL Series

Solid no lead brass (C69300-EcoBrass) PEX insert × female sweat adapters. SS press sleeves sold separately.

For complete specifications, see submittal [SUB27000NL](#).

WSL

Stk#	Description	Pkg Qty	Carton Qty	Unit	List Price / Unit
27205NL	½" PEX × ½" F/Sweat No Lead Brass Adapter	25	700	ea.	\$ 3.886
27222NL	¾" PEX × ¾" F/Sweat No Lead Brass Adapter	25	400	ea.	\$ 6.955
27328NL	¾" PEX × 1" F/Sweat No Lead Adapter	10	100	ea.	\$ 7.540
27228NL	1" PEX × 1" F/Sweat No Lead Brass Adapter	10	200	ea.	\$ 16.825
27235NL	1-¼" PEX × 1-¼" F/Sweat No Lead Brass Adapter	5	120	ea.	\$ 25.409

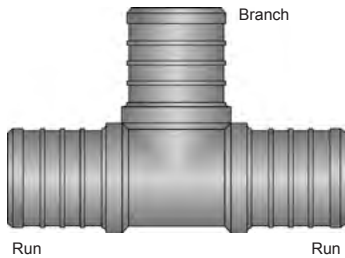

PEX Insert Tees - **No Lead Brass** 26000NL Series

Solid no lead brass (C69300-EcoBrass) PEX insert tees. SS press sleeves sold separately.

For complete specifications, see submittal [SUB26000NL](#).

Stk#	Description (run × run × branch)	Pkg Qty	Carton Qty	Unit	List Price / Unit
26555NL	½" × ½" × ½" PEX No Lead Brass Tee	25	250	ea.	\$ 5.310
26222NL	¾" × ¾" × ¾" PEX No Lead Brass Tee	25	250	ea.	\$ 8.468
26888NL	1" × 1" × 1" PEX No Lead Brass Tee	10	100	ea.	\$ 18.106
26333NL	1-¼" × 1-¼" × 1-¼" PEX No Lead Brass Tee	5	80	ea.	\$ 42.892
26444NL	1-½" × 1-½" × 1-½" PEX No Lead Brass Tee	5	30	ea.	\$ 88.620
26666NL	2" × 2" × 2" PEX No Lead Brass Tee	5	25	ea.	\$ 159.484

Note: 1-½" and larger fittings may be ordered in less than package quantities; no surcharge.

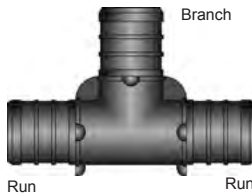

PEX Insert Tees - **HPP** 16000 Series

High Performance Polymer PEX insert tees. SS press sleeves sold separately.

For complete specifications, see submittal [SUB16000](#).

Stk#	Description (run × run × branch)	Pkg Qty	Carton Qty	Unit	List Price / Unit
16555	½" × ½" × ½" PEX HPP Tee	25	400	ea.	\$ 2.299
16222	¾" × ¾" × ¾" PEX HPP Tee	25	200	ea.	\$ 3.377
16888	1" × 1" × 1" PEX HPP Tee	10	100	ea.	\$ 9.008

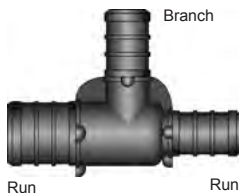

PEX Insert Reducing Tees - **HPP** 16000 Series

High Performance Polymer PEX insert reducing tees. SS press sleeves sold separately.

For complete specifications, see submittal [SUB16000](#).

Stk#	Description (run × run × branch)	Pkg Qty	Carton Qty	Unit	List Price / Unit
16552	½" × ½" × ¾" PEX HPP Tee	25	300	ea.	\$ 2.851
16225	¾" × ¾" × ½" PEX HPP Tee	25	250	ea.	\$ 3.160
16228	¾" × ¾" × 1" PEX HPP Tee	5	300	ea.	\$ 7.455
16255	¾" × ½" × ½" PEX HPP Tee	25	300	ea.	\$ 2.664
16252	¾" × ½" × ¾" PEX HPP Tee	25	250	ea.	\$ 3.362
16885	1" × 1" × ½" PEX HPP Tee	10	360	ea.	\$ 6.804
16882	1" × 1" × ¾" PEX HPP Tee	5	100	ea.	\$ 7.051
16822	1" × ¾" × ¾" PEX HPP Tee	5	320	ea.	\$ 7.631
16828	1" × ¾" × 1" PEX HPP Tee	5	300	ea.	\$ 7.158

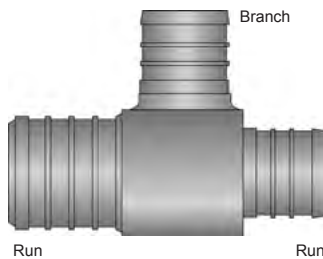

PEX Insert Reducing Tees - **No Lead Brass** 26000NL Series

Solid no lead brass (C69300-EcoBrass) PEX insert tees. SS press sleeves sold separately.

For complete specifications, see submittal [SUB26000NL](#).

	Stk#	Description (run × run × branch)	Pkg Qty	Carton Qty	Unit	List Price / Unit
WSL	26552NL	1/2" × 1/2" × 3/4" PEX No Lead Brass Tee	10	250	ea.	\$ 5.400
	26225NL	3/4" × 3/4" × 1/2" PEX No Lead Brass Tee	25	250	ea.	\$ 8.277
	26252NL	3/4" × 1/2" × 3/4" PEX No Lead Brass Tee	25	250	ea.	\$ 8.480
	26255NL	3/4" × 1/2" × 1/2" PEX No Lead Brass Tee	25	250	ea.	\$ 8.260
	26822NL	1" × 3/4" × 3/4" PEX No Lead Brass Tee	5	100	ea.	\$ 18.656
	26885NL	1" × 1" × 1/2" PEX No Lead Brass Tee	10	100	ea.	\$ 17.540
WSL	26882NL	1" × 1" × 3/4" PEX No Lead Brass Tee	5	100	ea.	\$ 20.268
	26322NL	1-1/4" × 3/4" × 3/4" PEX No Lead Brass Tee	5	100	ea.	\$ 26.330
	26382NL	1-1/4" × 1" × 3/4" PEX No Lead Brass Tee	5	100	ea.	\$ 39.555
	26388NL	1-1/4" × 1" × 1" PEX No Lead Brass Tee	5	100	ea.	\$ 45.765
	26335NL	1-1/4" × 1-1/4" × 1/2" PEX No Lead Brass Tee	5	100	ea.	\$ 34.091
	26332NL	1-1/4" × 1-1/4" × 3/4" PEX No Lead Brass Tee	5	80	ea.	\$ 41.491
WSL	26338NL	1-1/4" × 1-1/4" × 1" PEX No Lead Brass Tee	5	80	ea.	\$ 50.050
	26422NL	1-1/2" × 3/4" × 3/4" PEX No Lead Brass Tee	5	60	ea.	\$ 45.530
	26432NL	1-1/2" × 1-1/4" × 3/4" PEX No Lead Brass Tee	5	50	ea.	\$ 69.775
	26442NL	1-1/2" × 1-1/2" × 3/4" PEX No Lead Brass Tee	5	50	ea.	\$ 57.570
	26488NL	1-1/2" × 1" × 1" PEX No Lead Brass Tee	5	50	ea.	\$ 77.234
	26433NL	1-1/2" × 1-1/4" × 1-1/4" PEX No Lead Brass Tee	5	40	ea.	\$ 59.780
WSL	26448NL	1-1/2" × 1-1/2" × 1" PEX No Lead Brass Tee	5	40	ea.	\$ 83.247
	26443NL	1-1/2" × 1-1/2" × 1-1/4" PEX No Lead Brass Tee	5	40	ea.	\$ 65.150
WSL	26633NL	2" × 1-1/4" × 1-1/4" PEX No Lead Brass Tee	5	25	ea.	\$ 176.931
	26642NL	2" × 1-1/2" × 3/4" PEX No Lead Brass Tee	5	25	ea.	\$ 131.613
	26648NL	2" × 1-1/2" × 1" PEX No Lead Brass Tee	5	25	ea.	\$ 135.051
	26643NL	2" × 1-1/2" × 1-1/4" PEX No Lead Brass Tee	5	25	ea.	\$ 139.859
	26644NL	2" × 1-1/2" × 1-1/2" PEX No Lead Brass Tee	5	25	ea.	\$ 154.210
	26662NL	2" × 2" × 3/4" PEX No Lead Brass Tee	5	25	ea.	\$ 132.491
	26668NL	2" × 2" × 1" PEX No Lead Brass Tee	5	25	ea.	\$ 129.715
	26663NL	2" × 2" × 1-1/4" PEX No Lead Brass Tee	5	25	ea.	\$ 133.994
	26664NL	2" × 2" × 1-1/2" PEX No Lead Brass Tee	5	25	ea.	\$ 151.165

Note: 1-1/2" and larger fittings may be ordered in less than package quantities; no surcharge.

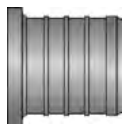

PEX Insert Plugs - **No Lead Brass** 25000NL Series

Solid no lead brass (C69300-EcoBrass) PEX insert plug. SS press sleeves sold separately.

For complete specifications, see submittal [SUB25000NL](#).

Stk#	Description	Pkg Qty	Carton Qty	Unit	List Price / Unit
25005NL	½" PEX No Lead Brass Plug	25	1200	ea.	\$ 2.532
25022NL	¾" PEX No Lead Brass Plug	25	1000	ea.	\$ 3.538
25028NL	1" PEX No Lead Brass Plug	5	510	ea.	\$ 5.086
25035NL	1-¼" PEX No Lead Brass Plug	5	260	ea.	\$ 13.743
25041NL	1-½" PEX No Lead Brass Plug	5	110	ea.	\$ 61.454
25054NL	2" PEX No Lead Brass Plug	5	25	ea.	\$ 61.556

Note: 1-½" and larger fittings may be ordered in less than package quantities; no surcharge.



PEX Insert Plugs - **HPP** 15000 Series

High Performance Polymer PEX insert plugs. SS press sleeves sold separately.

For complete specifications, see submittal [SUB15000](#).

Stk#	Description	Pkg Qty	Carton Qty	Unit	List Price / Unit
15005	½" PEX HPP Plug	25	2000	ea.	\$ 0.904
15022	¾" PEX HPP Plug	25	1000	ea.	\$ 1.481
15028	1" PEX HPP Plug	5	500	ea.	\$ 2.408

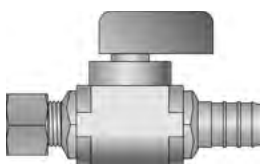

Plated Straight Ball Valve - **No Lead Brass**

Stk #23505NL

No lead brass (C69300-EcoBrass) 1/2" PEX x 3/8" O.D. compression, nickel plated straight ball valve. SS press sleeves sold separately.

For complete specifications, see submittal [SUB23505NL](#).

Stk#	Description	Pkg Qty	Carton Qty	Unit	List Price / Unit
23505NL	1/2" PEX x 3/8" O.D. No Lead Brass Plated Straight Ball Valve	24	144	ea.	\$ 29.655

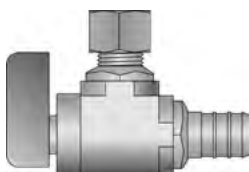

Plated Angle Ball Valve - **No Lead Brass**

Stk# 23605NL

No lead brass (C69300-EcoBrass) 1/2" PEX x 3/8" O.D. compression, nickel plated angle ball valve. SS press sleeves sold separately.

For complete specifications, see submittal [SUB23605NL](#).

Stk#	Description	Pkg Qty	Carton Qty	Unit	List Price / Unit
23605NL	1/2" PEX x 3/8" O.D. No Lead Brass Plated Angle Ball Valve	24	144	ea.	\$ 30.412



Straight Ball Valve - **No Lead Brass**

Stk# 23905NL

No lead brass (C69300-EcoBrass) 1/2" PEX x 1/4" O.D. compression, straight ball valve. SS press sleeves sold separately.

For complete specifications, see submittal [SUB23905NL](#).

Stk#	Description	Pkg Qty	Carton Qty	Unit	List Price / Unit
23905NL	1/2" PEX x 1/4" O.D. No Lead Straight Ball Valve	24	144	ea.	\$ 36.775



PEX Insert Straight Ball Valves - **No Lead Brass**

23700NL Series

No lead brass (C69300-EcoBrass) valve. SS press sleeves sold separately.

For complete specifications, see submittal [SUB23700NL](#).

Stk#	Description	Pkg Qty	Carton Qty	Unit	List Price / Unit
23705NL	1/2" PEX Straight No Lead Brass Ball Valve	24	144	ea.	\$ 31.861
23722NL	3/4" PEX Straight No Lead Brass Ball Valve	24	144	ea.	\$ 40.062



Stop and Waste Valves - **No Lead Brass**

23770NL Series

No lead brass (C69300-EcoBrass) stop and waste valves. SS press sleeves sold separately.

For complete specifications, see submittal [SUB23770NL](#).

	Stk#	Description	Pkg Qty	Carton Qty	Unit	List Price / Unit
WSL	23775NL	1/2" PEX No Lead Stop and Waste Valve	24	144	ea.	\$ 35.190
WSL	23772NL	3/4" PEX No Lead Stop and Waste Valve	12	72	ea.	\$ 43.740



1/2" PEX × 1/2" M/Sweat Straight Ball Valve - **No Lead Brass** Stk# 23405NL

No lead brass (C69300-EcoBrass) 1/2" PEX × 1/2" male sweat ball valve. SS press sleeves sold separately.

For complete specifications, see submittal [SUB23405NL](#).

WSL

Stk#	Description	Pkg Qty	Carton Qty	Unit	List Price / Unit
23405NL	1/2" PEX × 1/2" No Lead M/Sweat Straight Ball Valve	24	144	ea.	\$ 11.820



PEX Insert Ball Valves - **No Lead Brass** 23300NL Series

No lead brass PEX F1807 × PEX F1807 full port straight ball valves with lever handle. SS press sleeves sold separately.

For complete specifications, see submittal [SUB23300NL](#).

Coming Spring of 2022!

New!

Stk#	Description	Pkg Qty	Carton Qty	Unit	List Price / Unit
23305NL	1/2" PEX F1807 No Lead Brass Ball Valve, Full Port	10	120	ea.	\$ 12.560
23322NL	3/4" PEX F1807 No Lead Brass Ball Valve, Full Port	10	80	ea.	\$ 19.440
23328NL	1" PEX F1807 No Lead Brass Ball Valve, Full Port	6	48	ea.	\$ 33.860
23335NL	1-1/4" PEX F1807 No Lead Brass Ball Valve, Full Port	4	24	ea.	\$ 53.590
23341NL	1-1/2" PEX F1807 No Lead Brass Ball Valve, Full Port	2	16	ea.	\$ 72.900
23354NL	2" PEX F1807 No Lead Brass Ball Valve, Full Port	2	12	ea.	\$ 122.660

New!

New!

New!

New!

New!



PEX Insert × MNPT Ball Valves - **No Lead Brass** 23800NL Series

No lead brass PEX F1807 × MNPT straight ball valves with butterfly handle. SS press sleeves sold separately.

For complete specifications, see submittal [SUB23800NL](#).

Coming Spring of 2022!

New!

Stk#	Description	Pkg Qty	Carton Qty	Unit	List Price / Unit
23822NL	3/4" PEX F1807 × 3/4" MNPT No Lead Brass Ball Valve	10	80	ea.	\$ 26.180

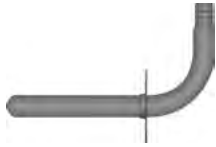

Stub-out Elbow with Edge Bracket Stk# 28205

Copper stub-out elbow allows for 90° transitions between fixtures and wall cavities. SS press sleeves sold separately.

For complete specifications, see submittal [SUB28205](#).

Stk#	Description	Pkg Qty	Carton Qty	Unit	List Price / Unit
28205	½" PEX Barb Stubout Elbow with Edge Bracket	25	100	ea.	\$ 17.500



Stub-out Elbow Stk# 28206

Copper stub-out elbow allows for 90° transitions between fixtures and wall cavities. SS press sleeves sold separately.

For complete specifications, see submittal [SUB28206](#).

Stk#	Description	Pkg Qty	Carton Qty	Unit	List Price / Unit
28206	½" PEX × Closed, 3-½" × 6" Stub-out Elbow	50		ea.	\$ 10.774

Look What's New!

Heat Link®

F1960 PEX-a Potable Water Expansion System



Fittings and Multiport Tees

High Performance Plastic (HPP) and No Lead (Eco)Brass fittings available in ½" to 2" for all of your plumbing needs.

PEX-a Expansion Rings

Uses the strong shape memory of PEX-a to form a tight seal. The PEX-a tubing and expansion ring are expanded with a specialized tool, and allowed to contract in order to form the connection. As the PEX-a contracts the connection will strengthen.

PureLink® Plus PEX-a Tubing

Cross-linked polyethylene tubing; crosslinking occurs during the extrusion process resulting in more uniform and higher degree in cross linking, as well as significantly improved material properties, such as flexibility, chemical resistance, and durability.

HeatLink F1960 Expansion System Advantages:

- Clean & non-toxic
- Resists scaling & corrosion
- Quiet – no water hammer noise
- Equalized pressure drops, minimize hot or cold surges
- Durable
- Reliable installation
- Low friction losses
- Meets all applicable North American approvals including:
 - » Domestic hot water continuous recirculation
 - » CAN/ULC S102/2010 and ASTM E84 plenum acceptance
- Flexible tubing means fewer fittings
- Discreet red/blue identification on PEX tubing
- Freeze resistant
- UV stabilized & chlorine resistance
- Connections can be checked visually
- Can't be dry fit

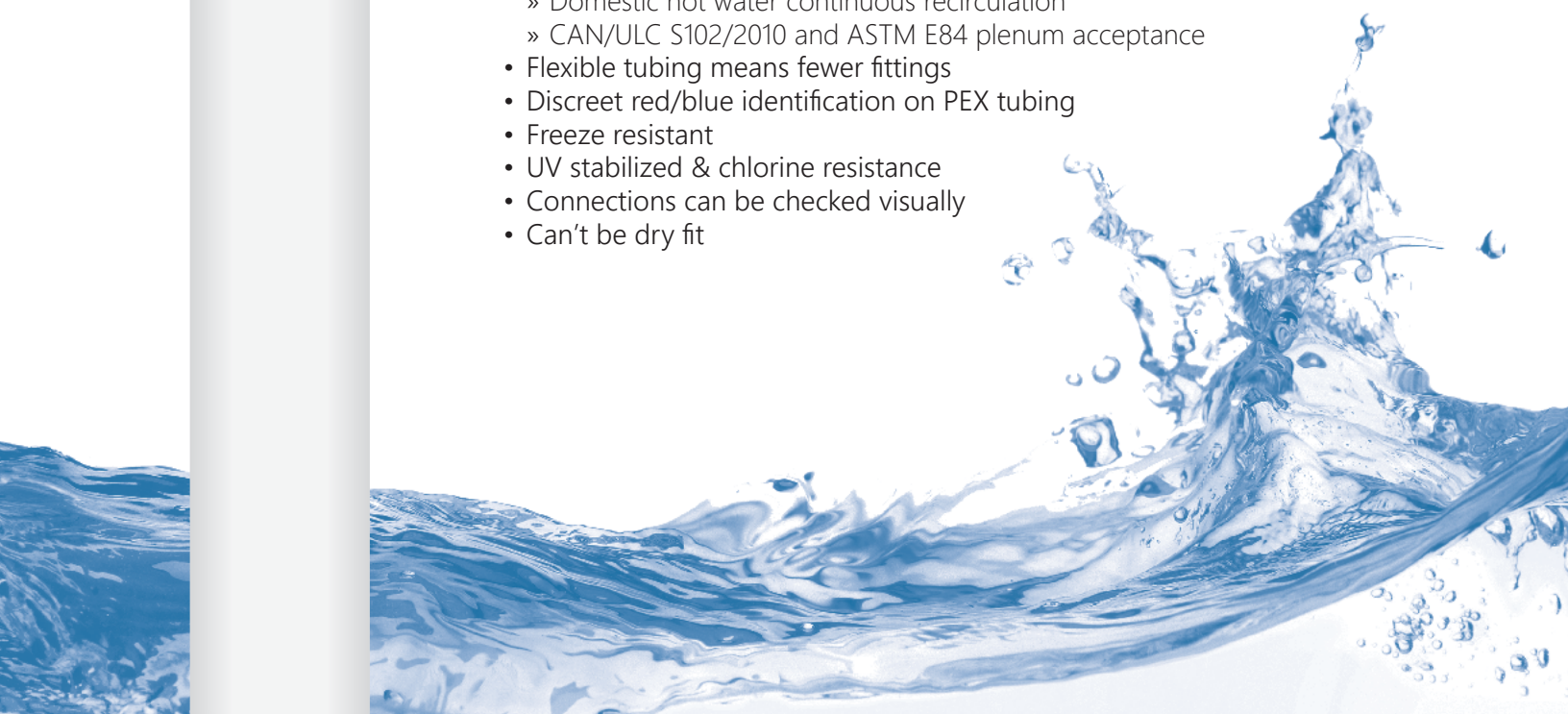

**PEX-a Expansion Rings with Stop
EX24200 Series**

PEX-a expansion rings with 360 degree stop collar for use with PEX F1960 fittings.

For complete specifications, see submittal [SUBEX24200](#).

Stk#	Description	Pkg Qty	Carton Qty	Unit	List Price / Unit
EX24205	½" PEX F1960 Expansion Ring	100	1000	ea.	\$ 0.544
EX24222	¾" PEX F1960 Expansion Ring	50	500	ea.	\$ 1.085
EX24228	1" PEX F1960 Expansion Ring	50	250	ea.	\$ 2.285
EX24235	1-¼" PEX F1960 Expansion Ring	10	150	ea.	\$ 2.671
EX24241	1-½" PEX F1960 Expansion Ring	10	100	ea.	\$ 3.482
EX24250	2" PEX F1960 Expansion Ring	5	50	ea.	\$ 7.099

**PEX F1960 Plugs - *HPP*
EX15000 Series**

High Performance Polymer PEX F1960 plugs. PEX-a expansion rings sold separately.

For complete specifications, see submittal [SUBEX15000](#).

Stk#	Description	Pkg Qty	Carton Qty	Unit	List Price / Unit
EX15005	½" PEX F1960 HPP Plug	25	1000	ea.	\$ 2.357
EX15022	¾" PEX F1960 HPP Plug	25	500	ea.	\$ 3.805
EX15028	1" PEX F1960 HPP Plug	5	600	ea.	\$ 5.059
EX15035	1-¼" PEX F1960 HPP Plug	1	50	ea.	\$ 23.819
EX15041	1-½" PEX F1960 HPP Plug	1	50	ea.	\$ 36.674
EX15054	2" PEX F1960 HPP Plug	1	50	ea.	\$ 41.746



PEX F1960 Closed End HPP Multiport Tees EX13000 Series

Closed one end and 3/4" or 1" PEX F1960 on the other end. 1/2" PEX F1960 branches in single row. PEX-a expansion rings sold separately.

For complete specifications, see submittal [SUBEX13000](#)

Stk#	Description	Pkg Qty	Carton Qty	Unit	List Price / Unit
EX13203	3 Port, 3/4" PEX F1960 × Closed End HPP Multiport Tee	5	80	ea.	\$ 17.319
EX13204	4 Port, 3/4" PEX F1960 × Closed End HPP Multiport Tee	5	60	ea.	\$ 24.619
EX13206	6 Port, 3/4" PEX F1960 × Closed End HPP Multiport Tee	5	40	ea.	\$ 30.293
EX13806	6 Port, 1" PEX F1960 × Closed End HPP Multiport Tee	5	40	ea.	\$ 71.725



PEX F1960 Flow Through HPP Multiport Tees EX14000 Series

Open on both ends with 3/4" or 1" PEX F1960 connections. 1/2" PEX F1960 branches in single row. PEX-a expansion rings sold separately.

For complete specifications, see submittal [SUBEX14000](#).

Stk#	Description	Pkg Qty	Carton Qty	Unit	List Price / Unit
EX14202	2 Port, 3/4" × 3/4" PEX F1960 Flow Through HPP Multiport Tee	5	100	ea.	\$ 14.828
EX14203	3 Port, 3/4" × 3/4" PEX F1960 Flow Through HPP Multiport Tee	5	80	ea.	\$ 20.106
EX14204	4 Port, 3/4" × 3/4" PEX F1960 Flow Through HPP Multiport Tee	5	60	ea.	\$ 25.052
EX14706	6 Port, 1" × 3/4" PEX F1960 Flow Through HPP Multiport Tee	5	40	ea.	\$ 71.606

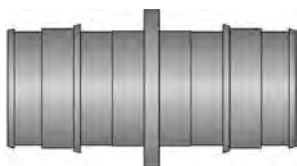

PEX F1960 Couplings - **No Lead Brass** EX29000NL Series

Solid no lead brass (C69300-EcoBrass) PEX F1960 × PEX F1960 couplings. PEX-a expansion rings sold separately.

For complete specifications, see submittal [SUBEX29000NL](#).

Stk#	Description	Pkg Qty	Carton Qty	Unit	List Price / Unit
EX29005NL	½" × ½" PEX F1960 No Lead Brass Coupling	25	500	ea.	\$ 9.576
EX29022NL	¾" × ¾" PEX F1960 No Lead Brass Coupling	25	250	ea.	\$ 14.802
EX29028NL	1" × 1" PEX F1960 No Lead Brass Coupling	10	250	ea.	\$ 27.752

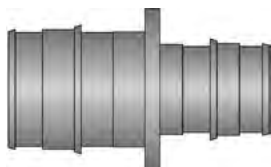

PEX F1960 Reducing Couplings - **No Lead Brass** EX29200NL Series

Solid no lead brass (C69300-EcoBrass) PEX F1960 × PEX F1960 reducing couplings. PEX-a expansion rings sold separately.

For complete specifications, see submittal [SUBEX29000NL](#).

Stk#	Description	Pkg Qty	Carton Qty	Unit	List Price / Unit
EX29225NL	¾" × ½" PEX F1960 No Lead Brass Coupling	25	500	ea.	\$ 12.912
EX29282NL	1" × ¾" PEX F1960 No Lead Brass Coupling	10	250	ea.	\$ 22.848



PEX F1960 Couplings - **HPP** EX19000 Series

High Performance Polymer PEX F1960 couplings. PEX-a expansion rings sold separately.

For complete specifications, see submittal [SUBEX19000](#).

Stk#	Description	Pkg Qty	Carton Qty	Unit	List Price / Unit
EX19005	½" × ½" PEX F1960 HPP Coupling	25	600	ea.	\$ 3.151
EX19022	¾" × ¾" PEX F1960 HPP Coupling	25	300	ea.	\$ 3.861
EX19028	1" × 1" PEX F1960 HPP Coupling	10	100	ea.	\$ 6.204
EX19035	1-¼" × 1-¼" PEX F1960 HPP Coupling	1	50	ea.	\$ 14.718
EX19041	1-½" × 1-½" PEX F1960 HPP Coupling	1	50	ea.	\$ 16.149
EX19054	2" × 2" PEX F1960 HPP Coupling	1	50	ea.	\$ 74.159



PEX F1960 Reducing Couplings - **HPP** EX19200 Series

High Performance Polymer PEX F1960 reducing couplings. PEX-a expansion rings sold separately.

For complete specifications, see submittal [SUBEX19000](#).

Stk#	Description	Pkg Qty	Carton Qty	Unit	List Price / Unit
EX19225	¾" × ½" PEX F1960 HPP Coupling	25	300	ea.	\$ 6.179
EX19282	1" × ¾" PEX F1960 HPP Coupling	5	150	ea.	\$ 9.419
EX19238	1-¼" × 1" PEX F1960 HPP Coupling	1	50	ea.	\$ 12.986
EX19243	1-½" × 1-¼" PEX F1960 HPP Coupling	1	50	ea.	\$ 15.911
EX19248	1-½" × 1" PEX F1960 HPP Coupling	1	50	ea.	\$ 15.938
EX19264	2" × 1-½" PEX F1960 HPP Coupling	1	50	ea.	\$ 60.083

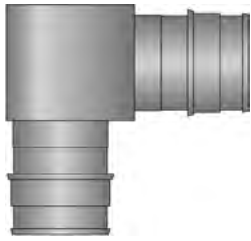

PEX F1960 Elbows - **No Lead Brass** EX28000NL Series

Solid no lead brass (C69300-EcoBrass) PEX F1960 × PEX F1960 elbows. PEX-a expansion rings sold separately.

For complete specifications, see submittal [SUBEX28000NL](#).

Stk#	Description	Pkg Qty	Carton Qty	Unit	List Price / Unit
EX28005NL	½" × ½" PEX F1960 No Lead Brass Elbow	25	250	ea.	\$ 11.580
EX28022NL	¾" × ¾" PEX F1960 No Lead Brass Elbow	25	250	ea.	\$ 19.529
EX28028NL	1" × 1" PEX F1960 No Lead Brass Elbow	10	100	ea.	\$ 30.830



PEX F1960 Elbows - **HPP** EX18000 Series

High Performance Polymer PEX F1960 elbows. PEX-a expansion rings sold separately.

For complete specifications, see submittal [SUBEX18000](#).

Stk#	Description	Pkg Qty	Carton Qty	Unit	List Price / Unit
EX18005	½" × ½" PEX F1960 HPP Elbow	25	500	ea.	\$ 3.745
EX18022	¾" × ¾" PEX F1960 HPP Elbow	25	300	ea.	\$ 4.760
EX18028	1" × 1" PEX F1960 HPP Elbow	10	100	ea.	\$ 9.971
EX18035	1-¼" × 1-¼" PEX F1960 HPP Elbow	1	50	ea.	\$ 22.218
EX18041	1-½" × 1-½" PEX F1960 HPP Elbow	1	50	ea.	\$ 29.700
EX18054	2" × 2" PEX F1960 HPP Elbow	1	50	ea.	\$ 108.119



PEX F1960 × MNPT Adapters - **No Lead Brass** EX27500NL Series

Solid brass no lead (C69300-EcoBrass) PEX F1960 × MNPT adapters. PEX-a expansion rings sold separately.

For complete specifications, see submittal [SUBEX27500NL](#).

Stk#	Description	Pkg Qty	Carton Qty	Unit	List Price / Unit
EX27505NL	½" PEX F1960 × ½" MNPT No Lead Brass Adapter	25	250	ea.	\$ 9.033
EX27522NL	¾" PEX F1960 × ¾" MNPT No Lead Brass Adapter	25	250	ea.	\$ 16.243
EX27528NL	1" PEX F1960 × 1" MNPT No Lead Brass Adapter	10	150	ea.	\$ 33.186
EX27535NL	1-¼" PEX F1960 × 1-¼" MNPT No Lead Brass Adapter	5	70	ea.	\$ 72.202
EX27541NL	1-½" PEX F1960 × 1-½" MNPT No Lead Brass Adapter	5	25	ea.	\$ 97.385
EX27554NL	2" PEX F1960 × 2" MNPT No Lead Brass Adapter	5	10	ea.	\$ 284.296

Note: 1-½" and larger fittings may be ordered in less than package quantities; no surcharge.



PEX F1960 × MNPT Adapters - **HPP** EX17500 Series

High Performance Polymer PEX F1960 × MNPT adapters. PEX-a expansion rings sold separately.

For complete specifications, see submittal [SUBEX17500](#).

Stk#	Description	Pkg Qty	Carton Qty	Unit	List Price / Unit
EX17505	½" PEX F1960 × ½" MNPT HPP Adapter	25	375	ea.	\$ 3.240
EX17552	½" PEX F1960 × ¾" MNPT HPP Adapter	25	350	ea.	\$ 4.156
EX17522	¾" PEX F1960 × ¾" MNPT HPP Adapter	25	300	ea.	\$ 5.372



PEX F1960 Drop Ear Elbows - **No Lead Brass** EX28300NL Series

Solid no lead brass (C69300-EcoBrass) ½" PEX F1960 × ½" FNPT drop ear elbow. PEX-a expansion rings sold separately.

For complete specifications, see submittal [SUBEX28300NL](#).

Stk#	Description	Pkg Qty	Carton Qty	Unit	List Price / Unit
EX28305NL	½" PEX F1960 × ½" FNPT Drop Ear No Lead Brass Elbow	10	160	ea.	\$ 23.568

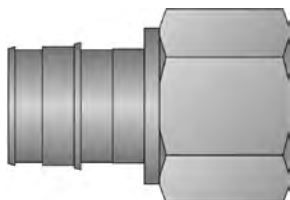

PEX F1960 × FNPT Adapters - **No Lead Brass** EX27600NL Series

Solid no lead brass (C69300-EcoBrass) PEX F1960 × FNPT adapters. PEX-a expansion rings sold separately.

For complete specifications, see submittal [SUBEX27600NL](#).

Stk#	Description	Pkg Qty	Carton Qty	Unit	List Price / Unit
EX27605NL	½" PEX F1960 × ½" FNPT No Lead Brass Adapter	25	400	ea.	\$ 17.573
EX27622NL	¾" PEX F1960 × ¾" FNPT No Lead Brass Adapter	25	300	ea.	\$ 20.376
EX27628NL	1" PEX F1960 × 1" FNPT No Lead Brass Adapter	25	150	ea.	\$ 42.925
EX27635NL	1-¼" PEX F1960 × 1-¼" FNPT No Lead Brass Adapter	5	70	ea.	\$ 77.912
EX27641NL	1-½" PEX F1960 × 1-½" FNPT No Lead Brass Adapter	5	35	ea.	\$ 157.609

Note: 1-½" and larger fittings may be ordered in less than package quantities; no surcharge.



PEX F1960 × Swivel Adapters - **HPP** 17700 Series

High Performance Polymer PEX F1960 × swivel adapters. PEX-a expansion rings sold separately.

For complete specifications, see submittal [SUBEX17700](#).

Stk#	Description	Pkg Qty	Carton Qty	Unit	List Price / Unit
EX17755	½" PEX F1960 × ½" Swivel HPP Adapter	25	400	ea.	\$ 5.928



PEX F1960 × Male Sweat Adapters - **No Lead Brass** 27100NL Series

Solid no lead brass (C69300-EcoBrass) PEX F1960 × male sweat adapters. PEX-a expansion rings sold separately.

Not intended for use with copper press fittings.

For complete specifications, see submittal [SUBEX27000NL](#).

Stk#	Description	Pkg Qty	Carton Qty	Unit	List Price / Unit
EX27105NL	½" PEX F1960 × ½" M/Sweat No Lead Brass Adapter	25	700	ea.	\$ 6.126
EX27122NL	¾" PEX F1960 × ¾" M/Sweat No Lead Brass Adapter	25	400	ea.	\$ 13.407
EX27128NL	1" PEX F1960 × 1" M/Sweat No Lead Brass Adapter	10	200	ea.	\$ 25.909
EX27135NL	1-¼" PEX F1960 × 1-¼" M/Sweat No Lead Brass Adapter	5	40	ea.	\$ 54.483
EX27141NL	1-½" PEX F1960 × 1-½" M/Sweat No Lead Brass Adapter	5	30	ea.	\$ 89.544
EX27154NL	2" PEX F1960 × 2" M/Sweat No Lead Brass Adapter	5	20	ea.	\$ 247.828

Note: 1-½" and larger fittings may be ordered in less than package quantities; no surcharge.

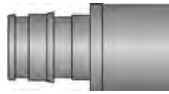

PEX F1960 × Female Sweat Adapters - **No Lead Brass** 27200NL Series

Solid no lead brass (C69300-EcoBrass) PEX F1960 × female sweat adapters. PEX-a expansion rings sold separately.

Not intended for use with copper press fittings.

For complete specifications, see submittal [SUBEX27000NL](#).

Stk#	Description	Pkg Qty	Carton Qty	Unit	List Price / Unit
EX27205NL	½" PEX F1960 × ½" F/Sweat No Lead Brass Adapter	25	700	ea.	\$ 6.261
EX27222NL	¾" PEX F1960 × ¾" F/Sweat No Lead Brass Adapter	25	400	ea.	\$ 14.250
EX27228NL	1" PEX F1960 × 1" F/Sweat No Lead Brass Adapter	10	200	ea.	\$ 23.732
EX27235NL	1-¼" PEX F1960 × 1-¼" F/Sweat No Lead Brass Adapter	5	70	ea.	\$ 64.761
EX27241NL	1-½" PEX F1960 × 1-½" F/Sweat No Lead Brass Adapter	5		ea.	\$ 99.230
EX27254NL	2" PEX F1960 × 2" F/Sweat No Lead Brass Adapter	5		ea.	\$ 263.330

Note: 1-½" and larger fittings may be ordered in less than package quantities; no surcharge.

Spring
2022

Spring
2022

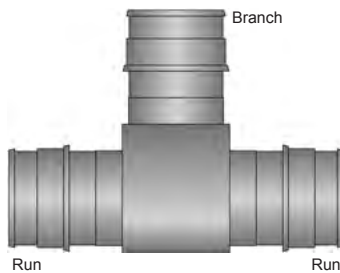

PEX F1960 Tees - **No Lead Brass** EX26000NL Series

Solid no lead brass (C69300-EcoBrass) PEX F1960 tees. PEX-a expansion rings sold separately.

For complete specifications, see submittal [SUBEX26000NL](#).

Stk#	Description (run × run × branch)	Pkg Qty	Carton Qty	Unit	List Price / Unit
EX26555NL	½" × ½" × ½" PEX F1960 No Lead Brass Tee	25	250	ea.	\$ 16.654
EX26222NL	¾" × ¾" × ¾" PEX F1960 No Lead Brass Tee	25	250	ea.	\$ 27.372
EX26888NL	1" × 1" × 1" PEX F1960 No Lead Brass Tee	10	100	ea.	\$ 47.207

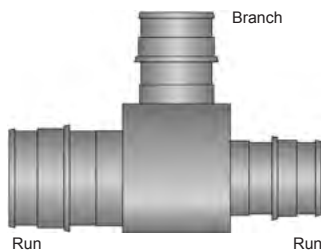

PEX F1960 Reducing Tees - **No Lead Brass** EX26000NL Series

Solid no lead brass (C69300-EcoBrass) PEX F1960 tees. PEX-a expansion rings sold separately.

For complete specifications, see submittal [SUBEX26000NL](#).

Stk#	Description (run × run × branch)	Pkg Qty	Carton Qty	Unit	List Price / Unit
EX26225NL	¾" × ¾" × ½" PEX F1960 No Lead Brass Tee	25	250	ea.	\$ 27.275
EX26252NL	¾" × ½" × ¾" PEX F1960 No Lead Brass Tee	25	250	ea.	\$ 22.958
EX26255NL	¾" × ½" × ½" PEX F1960 No Lead Brass Tee	25	250	ea.	\$ 23.253
EX26822NL	1" × ¾" × ¾" PEX F1960 No Lead Brass Tee	5	100	ea.	\$ 49.645
EX26882NL	1" × 1" × ¾" PEX F1960 No Lead Brass Tee	5	100	ea.	\$ 50.512
EX26885NL	1" × 1" × ½" PEX F1960 No Lead Brass Tee	10	100	ea.	\$ 49.453

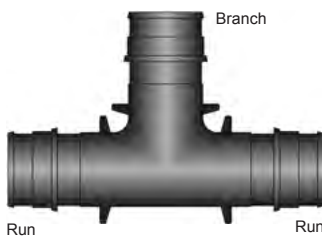

PEX F1960 Tees - **HPP** EX16000 Series

High Performance Polymer PEX F1960 tees. PEX-a expansion rings sold separately.

For complete specifications, see submittal [SUBEX16000](#).

Stk#	Description (run × run × branch)	Pkg Qty	Carton Qty	Unit	List Price / Unit
EX16555	½" × ½" × ½" PEX F1960 HPP Tee	25	250	ea.	\$ 3.812
EX16222	¾" × ¾" × ¾" PEX F1960 HPP Tee	25	100	ea.	\$ 6.074
EX16888	1" × 1" × 1" PEX F1960 HPP Tee	10	60	ea.	\$ 11.131
EX16333	1-¼" × 1-¼" × 1-¼" PEX F1960 HPP Tee	1	50	ea.	\$ 24.944
EX16444	1-½" × 1-½" × 1-½" PEX F1960 HPP Tee	1	50	ea.	\$ 36.779
EX16666	2" × 2" × 2" PEX F1960 HPP Tee	1	50	ea.	\$ 130.423

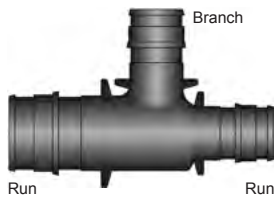

PEX F1960 Reducing Tees - *HPP* EX16000 Series

High Performance Polymer PEX F1960 reducing tees. PEX-a expansion rings sold separately.

For complete specifications, see submittal [SUBEX16000](#).

Stk#	Description (run × run × branch)	Pkg Qty	Carton Qty	Unit	List Price / Unit
EX16255	¾" × ½" × ½" PEX F1960 HPP Tee	25	200	ea.	\$ 5.753
EX16225	¾" × ¾" × ½" PEX F1960 HPP Tee	25	175	ea.	\$ 5.079
EX16252	¾" × ½" × ¾" PEX F1960 HPP Tee	25	150	ea.	\$ 5.959
EX16552	½" × ½" × ¾" PEX F1960 HPP Tee	25	200	ea.	\$ 13.869
EX16822	1" × ¾" × ¾" PEX F1960 HPP Tee	5	75	ea.	\$ 9.859
EX16828	1" × ¾" × 1" PEX F1960 HPP Tee	5	60	ea.	\$ 11.635
EX16882	1" × 1" × ¾" PEX F1960 HPP Tee	5	75	ea.	\$ 11.198
EX16885	1" × 1" × ½" PEX F1960 HPP Tee	10	90	ea.	\$ 10.284
EX16332	1-¼" × 1-¼" × ¾" PEX F1960 HPP Tee	1	50	ea.	\$ 23.216
EX16335	1-¼" × 1-¼" × ½" PEX F1960 HPP Tee	1	50	ea.	\$ 17.905
EX16338	1-¼" × 1-¼" × 1" PEX F1960 HPP Tee	1	50	ea.	\$ 23.827
EX16382	1-¼" × 1" × ¾" PEX F1960 HPP Tee	1	50	ea.	\$ 19.757
EX16388	1-¼" × 1" × 1" PEX F1960 HPP Tee	1	50	ea.	\$ 23.389
EX16432	1-½" × 1-¼" × ¾" PEX F1960 HPP Tee	1	50	ea.	\$ 33.310
EX16433	1-½" × 1-¼" × 1-¼" PEX F1960 HPP Tee	1	50	ea.	\$ 36.851
EX16438	1-½" × 1-¼" × 1" PEX F1960 HPP Tee	1	50	ea.	\$ 34.579
EX16442	1-½" × 1-½" × ¾" PEX F1960 HPP Tee	1	50	ea.	\$ 30.934
EX16443	1-½" × 1-½" × 1-¼" PEX F1960 HPP Tee	1	50	ea.	\$ 33.418
EX16448	1-½" × 1-½" × 1" PEX F1960 HPP Tee	1	50	ea.	\$ 31.907
EX16488	1-½" × 1" × 1" PEX F1960 HPP Tee	1	50	ea.	\$ 29.466
EX16642	2" × 1-½" × ¾" PEX F1960 HPP Tee	1	50	ea.	\$ 108.482
EX16643	2" × 1-½" × 1-¼" PEX F1960 HPP Tee	1	50	ea.	\$ 113.302
EX16644	2" × 1-½" × 1-½" PEX F1960 HPP Tee	1	50	ea.	\$ 124.112
EX16648	2" × 1-½" × 1" PEX F1960 HPP Tee	1	50	ea.	\$ 99.327
EX16662	2" × 2" × ¾" PEX F1960 HPP Tee	1	50	ea.	\$ 108.125
EX16663	2" × 2" × 1-¼" PEX F1960 HPP Tee	1	50	ea.	\$ 112.690
EX16664	2" × 2" × 1-½" PEX F1960 HPP Tee	1	50	ea.	\$ 128.727
EX16668	2" × 2" × 1" PEX F1960 HPP Tee	1	50	ea.	\$ 107.628



PEX F1960 Ball Valves - **No Lead Brass** EX23300NL Series

No lead brass PEX F1960 × PEX F1960 full port straight ball valves with lever handle. PEX-a expansion rings sold separately.

For complete specifications, see submittal [SUBEX23300NL](#).

Coming Spring of 2022!

	Stk#	Description	Pkg Qty	Carton Qty	Unit	List Price / Unit
New!	EX23305NL	½" PEX F1960 No Lead Brass Ball Valve, Full Port	10	120	ea.	\$ 15.320
New!	EX23322NL	¾" PEX F1960 No Lead Brass Ball Valve, Full Port	10	80	ea.	\$ 24.220
New!	EX23328NL	1" PEX F1960 No Lead Brass Ball Valve, Full Port	6	48	ea.	\$ 40.340
New!	EX23335NL	1-¼" PEX F1960 No Lead Brass Ball Valve, Full Port	4	24	ea.	\$ 64.660
New!	EX23341NL	1-½" PEX F1960 No Lead Brass Ball Valve, Full Port	2	16	ea.	\$ 89.540
New!	EX23354NL	2" PEX F1960 No Lead Brass Ball Valve, Full Port	2	12	ea.	\$ 168.180



PEX F1960 × MNPT Ball Valves - **No Lead Brass** EX23800NL Series

No lead brass PEX F1960 × MNPT straight ball valves with butterfly handle. PEX-a expansion rings sold separately.

For complete specifications, see submittal [SUBEX23800NL](#).

Coming Spring of 2022!

	Stk#	Description	Pkg Qty	Carton Qty	Unit	List Price / Unit
New!	EX23822NL	¾" PEX F1960 × ¾" MNPT No Lead Brass Ball Valve	10	80	ea.	\$ 25.850

Features & Benefits :

- Modular “tool-less” assembly.
- Multiple configurations ,all interchangeable; can be reconfigured on-site.
- Unlike a fixed loop manifold, loops can be added or removed as required.
- Stock is flexible, as there is no need to stock fixed-length manifolds. Minimal SKUs on the shelf.
- Maximum trunk flow rate: 11 US gpm (2.5 m³/h)
- Maximum circuit flow rate:
7830x - 1 US gpm (0.23 m³/h)
78200 - 1.25 US gpm (0.28 m³/h)
- ½", ⅝", and ¾" PEX to manifold connectors available.
- Test rated to over 230 PSI @ 180°F water temperature.
- 5 year limited warranty.

Typical Applications:

- Residential.
- Small commercial.

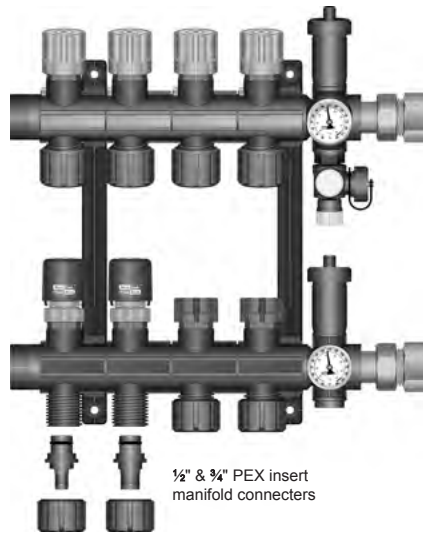

(79200 assembly kit shown with 78200 module pairs and 2 actuators)

78200 Module Specific Features:

- Flow balancing return.
- Zone valve supply with manual shut-off; accepts optional actuators.

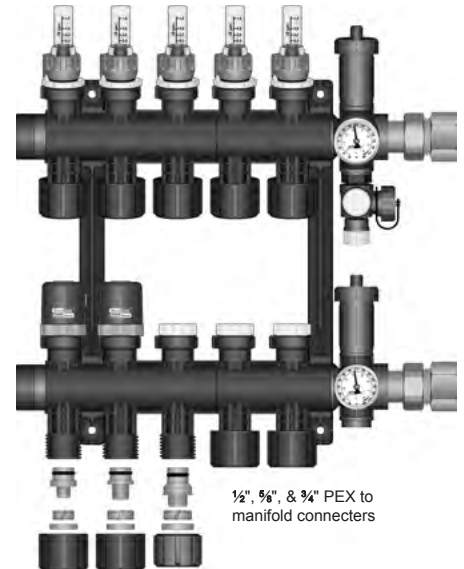

(79200 assembly kit shown with 78302 and 78303 module pairs and 2 actuators)

7830x Module Specific Features:

- Lockable balancing return with 0.4 - 1 US gpm (1.5 - 3.8 L/min) flow meter.
- Zone valve supply with manual shut-off; accepts optional actuators.

Assembly Kit	# of Loops	Choose Module Type		Additional Brackets	Recommended Housing*	
		Balancing	Multipoint Flow Meter		Recessed	Surface Mount with Rails
79200	2	2× 78200	1× 78302	-	71724	72434
	3	3× 78200	1× 78303	-	71724	72434
	4	4× 78200	2× 78302	-	71724	72434
	5	5× 78200	1× 78302 1× 78303	-	71730	72434
	6	6× 78200	2× 78303	1× 79892	71730	72434
	7	7× 78200	2× 78302 1× 78303	1× 79892	71730	72434
	8	8× 78200	1× 78302 2× 78303	1× 79892	71743	72434
	9	9× 78200	3× 78303	2× 79892	71743	72442
	10	10× 78200	2× 78302 2× 78303	2× 79892	71743	72442
	11	11× 78200	1× 78302 3× 78303	2× 79892	71743	72442
	12	12× 78200	4× 78303	3× 79892	71743	72442
	Actuator Selection					
	Actuator with LED	56200	56202			
	Actuator with End Switch	56230	56232			

Tubing Size	Tubing to Manifold Connectors / Loop		Conduit Elbows / Loop for “Wet” Installation
	Compression	PEX Insert	
½"	77005	2× 23015	2× 86005
⅝"	77019	n/a	2× 86020
¾"	77022	2× 23032	2× 86022

* Recommended housing based on 79200 kit and 90° mains piping



J-Clips 12000 Series

Fasten tubing to joists.

For complete specifications, see submittal [SUB12000](#).

Stk#	Description	Pkg Qty	Carton Qty	Unit	List Price / Unit
12005	½" J-Clip	100	2000	ea.	\$ 0.20
12022	¾" J-Clip	100	1000	ea.	\$ 0.24
12028	1" J-Clip	50	500	ea.	\$ 0.40



Plastic Bend Support 86100 Series

Allows for easy bending support and removal.

For complete specifications, see submittal [SUB86100](#).

Stk#	Description	Pkg Qty	Carton Qty	Unit	List Price / Unit
86105	Plastic Bend Support for ¾" and ½" Tubing	1	300	ea.	\$ 1.98
86122	Plastic Bend Support for ¾" Tubing	1	400	ea.	\$ 4.12



Metal Drop Ear Bend Support Stk# 86255

Allows for easy bending support and removal of a PEX tubing stub out from a wall or floor.

For complete specifications, see submittal [SUB86255](#).

Stk#	Description	Pkg Qty	Carton Qty	Unit	List Price / Unit
86255	Metal Drop Ear Bend Support for ½" Tubing	25	100	ea.	\$ 8.28

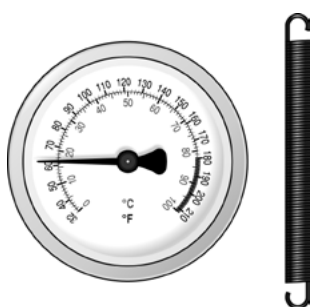

HeatLink® Strap-on Thermometer Stk# 76940

This surface mounted thermometer is used to measure surface temperatures of metallic piping. The Strap-on Thermometers can be mounted on pipe sizes ranging from 3/8" to 1-1/2". Suggested applications: Use on stainless steel manifolds or supply and return piping to measure water temperatures.

Range: 0 - 100°C, 32 - 212°F (dual scale)

For complete specifications, see submittal [SUB76940](#).

Stk#	Description	Pkg Qty	Carton Qty	Unit	List Price / Unit
76940	Strap-on Thermometer	1		ea.	\$ 44.54

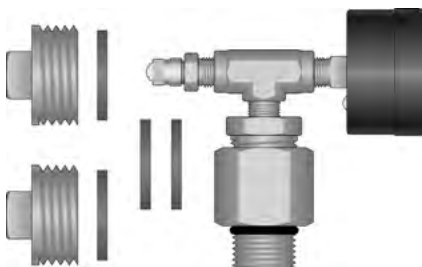

Pressure Test Kit Stk# 79935

Pressure test kit for use with heating manifolds.

TwistSeal® - replaces automatic air vent on cross tee for testing purposes.

Stainless Steel - replaces a flow meter or hose bib for testing purposes.

Kit includes two 1" plugs and 4 red rubber gaskets (2 are spares).

For air tests with the TwistSeal® Mini, use the red rubber gaskets; for hydrostatic tests use green fibre gaskets (included in manifold assembly kit).

For complete specifications, see submittal [SUB79935](#).

Stk#	Description	Pkg Qty	Carton Qty	Unit	List Price / Unit
79935	Pressure Test Kit	1		ea.	\$ 330.06

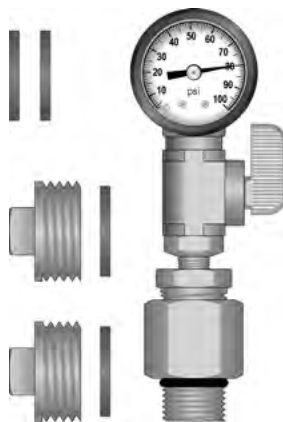

Pressure Test Kit with Valve Stk# 79965

Pressure test kit with valve for use with heating manifolds. The valve allows the gauge to be 'zeroed' and demonstrate the system is under pressure.

TwistSeal® - replaces automatic air vent on cross tee for testing purposes.

Stainless Steel - replaces a flow meter or hose bib for testing purposes.

Kit includes two 1" plugs and 4 red rubber gaskets (2 are spares).

For air tests with the TwistSeal® Mini, use the red rubber gaskets; for hydrostatic tests use green fibre gaskets (included in manifold assembly kit).

For complete specifications, see submittal [SUB79935](#).

Stk#	Description	Pkg Qty	Carton Qty	Unit	List Price / Unit
79965	Pressure Test Kit with Extra Valve to Zero Gauge	1		ea.	\$ 379.51

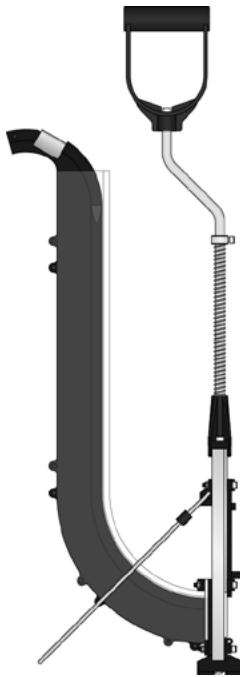

HeatLink® Deluxe Staple Gun Stk# 10230

Lightweight and easy to use manual staple gun. Use 89250 series staples to fasten up to 5/8" (or 20 mm O.D.) PEX tubing to polystyrene insulation.

For complete specifications, see submittal [SUB10230](#).

Stk#	Description	Pkg Qty	Carton Qty	Unit	List Price / Unit
10230	HeatLink® Deluxe Staple Gun	1		ea.	\$ 905.22

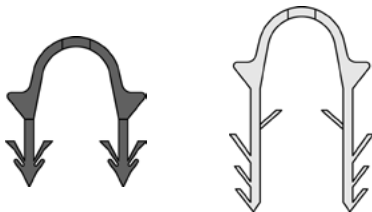

Staples for Deluxe Staple Gun 89250 Series

Staples for fastening up to 5/8" (or 20mm O.D.) PEX tubing to polystyrene insulation. For use with HeatLink® Deluxe Staple Gun #10230.

For complete specifications, see submittal [SUB89250](#).

Stk#	Description	Pkg Qty	Carton Qty	Unit	List Price / Unit
89251	300× 1-1/2" Staples for HeatLink® Deluxe Staple Gun	1	20	box	\$ 100.57
89252	300× 2" Staples for HeatLink® Deluxe Staple Gun	1	10	box	\$ 124.13



Staples for Stand-up Stapler (old style) 89240 Series

Staples for fastening up to 1/2" (or 18mm O.D.) PEX tubing to polystyrene insulation. For use with Stand-up Stapler #10220 (discontinued).

For complete specifications, see submittal [SUB89240](#).

Stk#	Description	Pkg Qty	Carton Qty	Unit	List Price / Unit
89244	300× 2-3/4" (60mm) Staples for Stand-up Stapler	1	20	box	\$ 77.66



HeatLink® Galvanized PEX Tubing Dispenser Stk# 10005

A PEX tubing dispenser is invaluable for tubing installation. Made of galvanized steel for long-term durability and maintenance free operation. Easy assembly and disassembly without tools.

Specifications:

- PEX diameter: up to ¾"
- Max coil weight: 114.6 lb (52 kg)
- Max coil height: 24" (60 cm)
- Min inner coil diameter: 11-½" (29 cm)
- Max outer coil diameter: 44" (112 cm)

For complete specifications, see submittal [SUB10005](#).

Stk#	Description	Pkg Qty	Carton Qty	Unit	List Price / Unit
10005	HeatLink Galvanized PEX Tubing Dispenser	1		ea.	\$ 745.56



PEX Tubing Cutters Stk# 10100

Quick precision cutting on PEX tubing or non-metallic tubing.

For complete specifications, see submittal [SUB10100](#).

Stk#	Description	Pkg Qty	Carton Qty	Unit	List Price / Unit
10100	HeatLink® PEX Tubing Cutters	1	50	ea.	\$ 25.03



PEX Tubing Cutter Stk# 10101

Radial tubing cutter for ½" and ¾" PEX. Keeps tubing round so fittings are easy to insert.

Stk#	Description	Pkg Qty	Carton Qty	Unit	List Price / Unit
10101	HeatLink Red PEX Pipe Cutter (QC ½" & ¾")	1		ea.	\$ 39.41



Multi-purpose Wrench Stk# 79922

Wrench for use with TwistSeal® and TwistSeal® Mini manifold module nut and valve base.

For complete specifications, see submittal [SUB79922](#).

Stk#	Description	Pkg Qty	Carton Qty	Unit	List Price / Unit
79922	Multiwrench for Manifold Nut and Base	1		ea.	\$ 19.11



Assembly Tool for TwistSeal® Mini Multiport Valves Stk# 78314

Tool used to remove and install TwistSeal® Mini Multiport valve cartridges.

Stk#	Description	Pkg Qty	Carton Qty	Unit	List Price / Unit
78314	Assembly tool for TwistSeal® Mini Multiport Valves	1		ea.	\$ 16.35

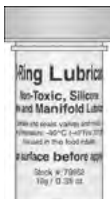

Non-Toxic Silicone O-Ring Lubricant Stk# 79951 & 79952

Lubrication for the manifold o-rings. Non-toxic silicone grease. Highly recommended for trouble free installation of manifold components.

For more information, see SDS alternative [L2801](#).

Stk#	Description	Pkg Qty	Carton Qty	Unit	List Price / Unit
79951	100g Bottle Non-toxic Silicone O-ring Lubricant	1		ea.	\$ 71.97
79952	10g Bottle Non-toxic Silicone O-ring Lubricant	1		ea.	\$ 14.89



Press Tool for Stainless Steel Sleeves 11300 Series

Designed to create a watertight seal, the Press Sleeve Tool has a toggle action handle. Easy to load and simple to press, the pressed stainless steel sleeve provides a finished appearance on the transition from the end of the PEX to the insert fitting.

For complete specifications, see submittal [SUB11300](#).

Stk#	Description	Pkg Qty	Carton Qty	Unit	List Price / Unit
11305	½" Standard Press Tool for SS Sleeve	1	10	ea.	\$ 467.14
11322	¾" Standard Press Tool for SS Sleeve	1	10	ea.	\$ 467.14
11325	½" & ¾" Combo Standard Press Tool for SS Sleeve	1	10	ea.	\$ 677.04
11328	1" Standard Press Tool for SS Sleeve	1	10	ea.	\$ 772.09
11335	1-¼" Standard Press Tool for SS Sleeve	1	10	ea.	\$ 1,155.57
11341	1-½" Standard Press Tool for SS Sleeve	1	10	ea.	\$ 1,319.86



Confined Space Press Tool for Stainless Steel Sleeves Stk# 11430 Series

The new Confined Space Press Tool is designed for one or two handed pressing and its unique design and expanded utility showcase HeatLink's focus on listening to the needs of customers and developing effective solutions for challenging situations. The Confined Space Tool is perfect for use in tight spaces where HPP Multiport Tees are used. It incorporates a "W" press profile for visual identification of an effective press and the handles can be opened in narrow spaces. The new tool is also smaller and lighter than the 11300 series press tools.

For complete specifications, see submittal [SUB11430](#).

Stk#	Description	Pkg Qty	Carton Qty	Unit	List Price / Unit
11433	½" Confined Space Press Tool	1	20	ea.	\$ 535.58
11434	¾" Confined Space Press Tool	1	20	ea.	\$ 535.72



Confined Space Press Tool for Stainless Steel Sleeves Stk# 11435

The Confined Space Press Tool comes with interchangeable collars for ½", ¾" and 1" PEX tubing. Adjustable lever allows for easier pressing with multiple squeezes. Comes with storage case.

For complete specifications, see submittal [SUB11435](#).

Stk#	Description	Pkg Qty	Carton Qty	Unit	List Price / Unit
11435	3-in-1 Confined Space Press Tool with Case	1		ea.	\$ 798.60



Slim-line Power Press Tool Stk# 11500

HeatLink's Slim-line Power Press Tool is designed for increased efficiency and reduced fatigue for plumbing and heating system installers. The new Slim-line tool makes larger diameter PEX connections effortless and has interchangeable jaws (sold separately) ranging from ½" to 1-½". Short pressing cycles of 3-4 seconds are now possible with HeatLink's new Slim-line tool and its efficiency is further supported by an extremely quick charging time of just 15 minutes. The tool is built using high quality and powerful Makita Li-Ion technology and incorporates biodegradable oil that is non-hazardous to water and has received the "Blue Angel" ecolabel.

Comes with one 18V 1.3Ah Li-ion battery, battery charger, and hard plastic case.

Jaws for the Power Press Tool are sold separately.

For complete specifications, see submittal [SUB11500](#).

Stk#	Description	Pkg Qty	Carton Qty	Unit	List Price / Unit
11500	Slim-line Power Press Tool	1		ea.	\$ 5,038.26



11505



11541

Jaws for Slim-line Power Press Tool 11500 Series

Jaws for use with the Slim-line Power Press Tool (#11500).

Compatible with the following third-party tools:

- Nibco PC-20M Mini
- Nibco PC-10M Mini
- Rothenberger Compact

May be compatible with other third-party tools, please contact your local representative to confirm.

For complete specifications, see submittal [SUB11505](#).

Stk#	Description	Pkg Qty	Carton Qty	Unit	List Price / Unit
11505	½" Jaws for Slim-line Power Press Tool	1	10	ea.	\$ 630.46
11522	¾" Jaws for Slim-line Power Press Tool	1	10	ea.	\$ 634.25
11528	1" Jaws for Slim-line Power Press Tool	1	10	ea.	\$ 666.89
11535	1-¼" Jaws for Slim-line Power Press Tool	1	10	ea.	\$ 665.38
11541	1-½" Jaws for Slim-line Power Press Tool	1	10	ea.	\$ 790.60



Power Press Tool with Pistol Grip Stk# 11600

HeatLink's new Pistol Grip Power Press Tool is designed for increased efficiency and reduced fatigue for plumbing and heating system installers. The Pistol Grip tool makes large diameter PEX connections effortless and features interchangeable jaws (sold separately) ranging from ½" to 2". Short pressing cycles of 3-4 seconds are now possible with HeatLink's new Pistol Grip tool, and its efficiency is further supported by an extremely quick charging time of just 15 minutes. The tool is built using high quality and powerful Makita Li-Ion technology and incorporates biodegradable oil that is non-hazardous to water and has received the "Blue Angel" ecolabel.

Comes with one 18V 1.3Ah Li-ion battery, battery charger, and hard plastic case.

Jaws for the Power Press Tool are sold separately.

For complete specifications, see submittal [SUB11600](#).

Stk#	Description	Pkg Qty	Carton Qty	Unit	List Price / Unit
11600	Power Press Tool with Pistol Grip	1		ea.	\$ 6,826.33

Jaws for Power Press Tool with Pistol Grip 11600 Series

Jaws compatible with the following third-party tools:

- Nibco PC-280
- Nibco PC-100
- Ridgid 320-E
- Ridgid RP330-B
- Ridgid CT400
- Ridgid RP330-C
- Ridgid RP340
- Milwaukee 2673-20
- Milwaukee 2673-20L
- Milwaukee 2773-20
- Milwaukee 2773-20L
- REMS 571011
- REMS 577010
- REMS 572111
- REMS 571013
- REMS 571014
- Victaulic Vic-Press™ Tool - Style PFT510

May be compatible with other third-party tools, please contact your local representative to confirm.

For complete specifications, see submittal [SUB11605](#).



11628

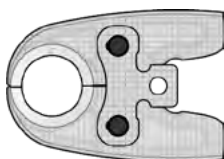

11654W

Stk#	Description	Pkg Qty	Carton Qty	Unit	List Price / Unit
11605	½" Jaws for Power Press Tool with Pistol Grip	1	10	ea.	\$ 700.78
11622	¾" Jaws for Power Press Tool with Pistol Grip	1	10	ea.	\$ 701.53
11628	1" Jaws for Power Press Tool with Pistol Grip	1	10	ea.	\$ 786.08
11635	1-¼" Jaws for Power Press Tool with Pistol Grip	1	12	ea.	\$ 805.74
11641	1-½" Jaws for Power Press Tool with Pistol Grip	1	8	ea.	\$ 871.89
11654W	2" Jaws for Power Press Tool with Pistol Grip	1		ea.	\$ 1,500.05

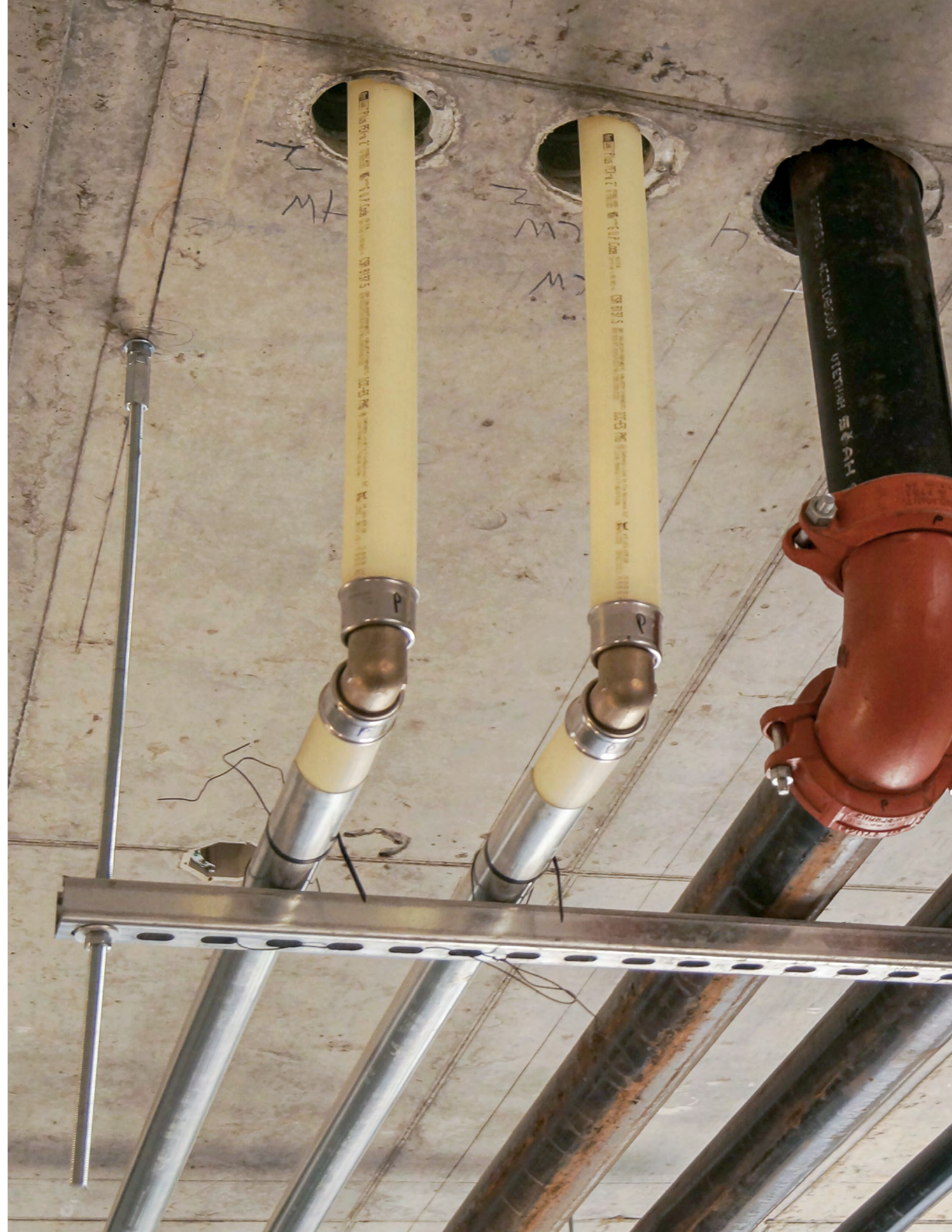



Toll Free: 1-800-323-1545
Fax: 1-888-800-8114

orders@heatlinkgroupusa.com
csr@heatlinkgroupusa.com
www.heatlink.com

Please check our website to ensure you have
the latest version of this catalog.

*HeatLink, DryAbove, DryBelow, EasyFit, EndBend, PexCube, PureLink, and SpacerClip are either registered
trademarks or trademarks of HeatLink Group Inc.*