

Stainless Steel Sinks



Part #	Model #	Description (Size)	MAKE SELECTION BELOW
DOUBLE BOWL UNDERMOUNT SINK (31 1/4" x 18" x 9")			
H75020	ASUD31189	18 GAUGE UNDERMOUNT	<input type="checkbox"/>

Installation Type: Undermount

Material: 304 Stainless Steel

Gauge: 18

Number of Bowls: 2

Sink Dimensions: 31 1/4" x 18" x 9"

Drain Location: Center

Cutout Template: 3 HOLE | 4 HOLE

Cutout Dimension: N/A

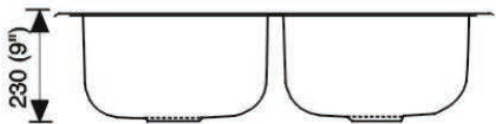

ADDITIONAL STAINLESS STEEL SINK DETAILS & INFORMATION

- One piece drawing, no welding and no center seam
- 304 Stainless Steel
- Meets UPC standards
- Sound deadening pads

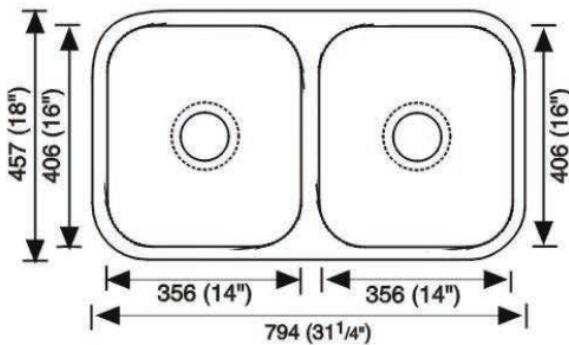

JOB NAME:

JOB LOCATION:

CONTRACTOR:

DATE:

ENGINEER APPROVAL:

DATE:

ITEM TAG:

PART NUMBER:



Sinks are listed by IAPMO® as meeting the applicable requirements of the Uniform Plumbing Code®, International Plumbing Code®, and National Plumbing Code of Canada.

Stainless Steel Sinks



Part #	Model #	Description (Size)	MAKE SELECTION BELOW
SINGLE BOWL UNDERMOUNT BAR SINK (16" x 16" x 8")			
H75021	ASUS16168	18 GAUGE UNDERMOUNT	<input type="checkbox"/>

Installation Type: Undermount

Material: 304 Stainless Steel

Gauge: 18

Number of Bowls: 1

Sink Dimensions: 16" x 16" x 8"

Drain Location: Center

Cutout Template: N/A

Cutout Dimension: N/A



ADDITIONAL STAINLESS STEEL SINK DETAILS & INFORMATION

- One piece drawing, no welding and no center seam
- 304 Stainless Steel
- Meets UPC standards
- Sound deadening pads

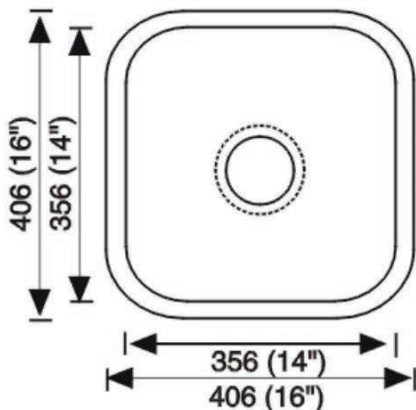

JOB NAME:

JOB LOCATION:

CONTRACTOR:

DATE:

ENGINEER APPROVAL:

DATE:

ITEM TAG:

PART NUMBER:



Sinks are listed by IAPMO® as meeting the applicable requirements of the Uniform Plumbing Code®, International Plumbing Code®, and National Plumbing Code of Canada.

Stainless Steel Sinks



Part #	Model #	Description (Size)	MAKE SELECTION BELOW
SINGLE BOWL UNDERMOUNT SINK (23" x 17 3/4" x 9")			
H75022	ASUS23189	18 GAUGE UNDERMOUNT	<input type="checkbox"/>

Installation Type: Undermount

Material: 304 Stainless Steel

Gauge: 18

Number of Bowls: 1

Sink Dimensions: 23" x 17 3/4" x 9"

Drain Location: Center

Cutout Template: N/A

Cutout Dimension: N/A



ADDITIONAL STAINLESS STEEL SINK DETAILS & INFORMATION

- One piece drawing, no welding and no center seam
- 304 Stainless Steel
- Meets UPC standards
- Sound deadening pads

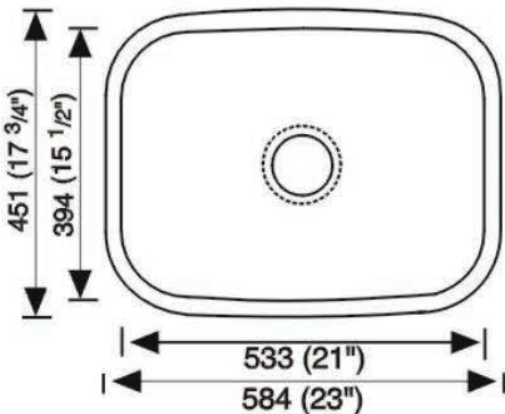

Sinks are listed by IAPMO® as meeting the applicable requirements of the Uniform Plumbing Code®, International Plumbing Code®, and National Plumbing Code of Canada.

JOB NAME:

JOB LOCATION:

CONTRACTOR:

DATE:

ENGINEER APPROVAL:

DATE:

ITEM TAG:

PART NUMBER:

Stainless Steel Sinks



Part #	Model #	Description (Size)	MAKE SELECTION BELOW
60/40 UNDERMOUNT SINK (20 3/4" x 32" x 9")			
-	SSS4621329	UNDERMOUNT 40/60	<input type="checkbox"/>

Installation Type: Undermount

Material: 304 Stainless Steel

Gauge: 18

Number of Bowls: 2

Sink Dimensions: 32" x 20 3/4" x 9"

Drain Location: Center

Cutout Template: N/A

Cutout Dimension: N/A

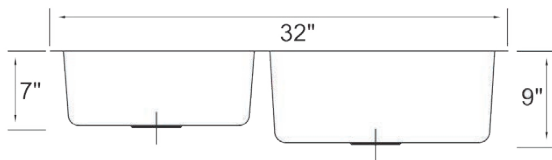

ADDITIONAL STAINLESS STEEL SINK DETAILS & INFORMATION

- One piece drawing, no welding and no center seam
- 304 Stainless Steel
- Meets UPC standards
- Sound deadening pads

JOB NAME:

JOB LOCATION:

CONTRACTOR:

DATE:

ENGINEER APPROVAL:

DATE:

ITEM TAG:

PART NUMBER:

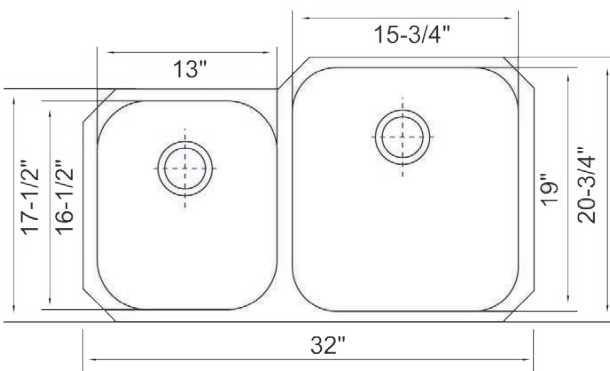

Sinks are listed by IAPMO® as meeting the applicable requirements of the Uniform Plumbing Code®, International Plumbing Code®, and National Plumbing Code of Canada.

Stainless Steel Sinks



Part #	Model #	Description (Size)	MAKE SELECTION BELOW
SINGLE BOWL UNDERMOUNT SINK (30" x 18" x 9")			
H75025	HPUSBKS30189	18 GAUGE UNDERMOUNT	<input type="checkbox"/>

Installation Type: Undermount

Material: 304 Stainless Steel

Gauge: 18

Number of Bowls: 1

Sink Dimensions: 30" x 18" x 9"

Drain Location: Center

Cutout Template: N/A

Cutout Dimension: N/A

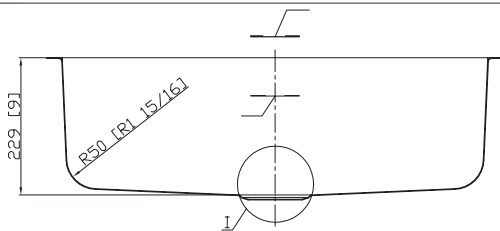

ADDITIONAL STAINLESS STEEL SINK DETAILS & INFORMATION

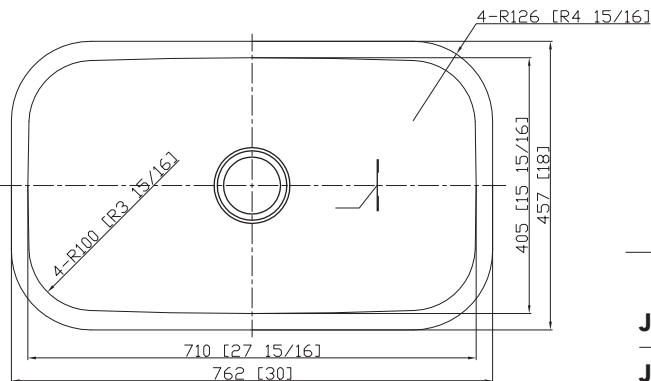

- One piece drawing, no welding and no center seam
- 304 Stainless Steel
- Meets UPC standards
- Sound deadening pads

JOB NAME:

JOB LOCATION:

CONTRACTOR:

DATE:

ENGINEER APPROVAL:

DATE:

ITEM TAG:

PART NUMBER:



Sinks are listed by IAPMO® as meeting the applicable requirements of the Uniform Plumbing Code®, International Plumbing Code®, and National Plumbing Code of Canada.

Stainless Steel Sinks



Part #	Model #	Description (Size)	MAKE SELECTION BELOW
SINGLE BOWL KITCHEN SINK (25" x 22" x 6")			
-	HPT25223624	23 GAUGE 3 HOLE	<input type="checkbox"/>
-	HPT25224624	23 GAUGE 4 HOLE	<input type="checkbox"/>

Installation Type: Drop In

Material: 304 Stainless Steel

Gauge: 23

Number of Bowls: 1

Sink Dimensions: 25" x 22" x 8"

Drain Location: Center

Cutout Template: 3 HOLE | 4 HOLE

Cutout Dimension: N/A

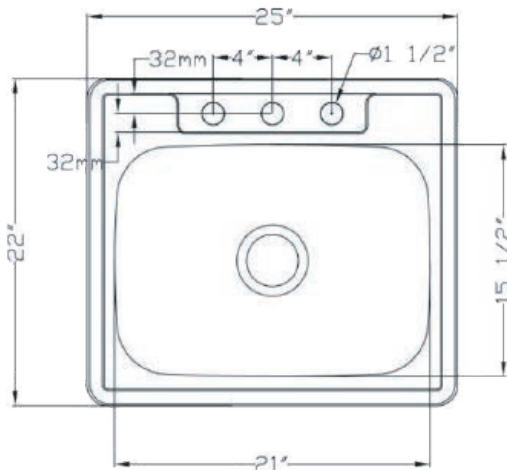

ADDITIONAL STAINLESS STEEL SINK DETAILS & INFORMATION

- One piece drawing, no welding and no center seam
- 304 Stainless Steel
- Meets UPC standards
- Sound deadening pads

JOB NAME:

JOB LOCATION:

CONTRACTOR:

DATE:

ENGINEER APPROVAL:

DATE:

ITEM TAG:

PART NUMBER:



Sinks are listed by IAPMO® as meeting the applicable requirements of the Uniform Plumbing Code®, International Plumbing Code®, and National Plumbing Code of Canada.

Stainless Steel Sinks



Part #	Model #	Description (Size)	MAKE SELECTION BELOW
SINGLE BOWL KITCHEN SINK (25" x 22" x 8")			
-	HPT25223820	20 GAUGE 3 HOLE	<input type="checkbox"/>
-	HPT25224822	20 GAUGE 4 HOLE	<input type="checkbox"/>

Installation Type: Drop In

Material: 304 Stainless Steel

Gauge: 20

Number of Bowls: 1

Sink Dimensions: 25" x 22" x 8"

Drain Location: Center

Cutout Template: 3 HOLE | 4 HOLE

Cutout Dimension: N/A

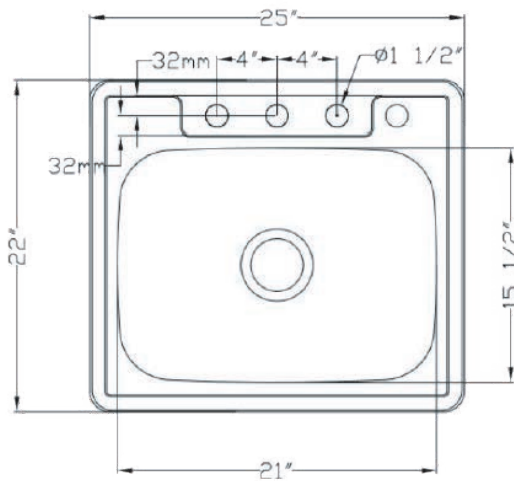

ADDITIONAL STAINLESS STEEL SINK DETAILS & INFORMATION

- One piece drawing, no welding and no center seam
- 304 Stainless Steel
- Meets UPC standards
- Sound deadening pads

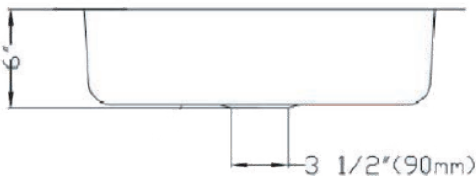

Sinks are listed by IAPMO® as meeting the applicable requirements of the Uniform Plumbing Code®, International Plumbing Code®, and National Plumbing Code of Canada.

JOB NAME:

JOB LOCATION:

CONTRACTOR:

DATE:

ENGINEER APPROVAL:

DATE:

ITEM TAG:

PART NUMBER:

Stainless Steel Sinks



Part #	Model #	Description (Size)	MAKE SELECTION BELOW
60/40 UNDERMOUNT SINK (32" x 20 3/4" x 9")			
-	SSS6432219	UNDERMOUNT 60/40	<input type="checkbox"/>

Installation Type: Undermount

Material: 304 Stainless Steel

Gauge: 18

Number of Bowls: 2

Sink Dimensions: 32" x 20 3/4" x 9"

Drain Location: Center

Cutout Template: N/A

Cutout Dimension: N/A

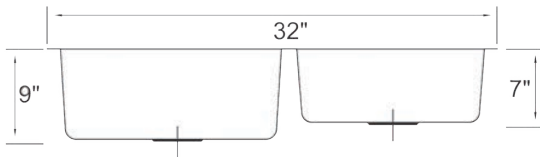

ADDITIONAL STAINLESS STEEL SINK DETAILS & INFORMATION

- One piece drawing, no welding and no center seam
- 304 Stainless Steel
- Meets UPC standards
- Sound deadening pads

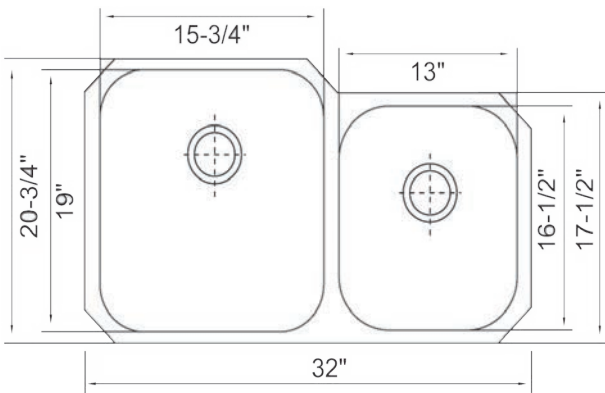

Sinks are listed by IAPMO® as meeting the applicable requirements of the Uniform Plumbing Code®, International Plumbing Code®, and National Plumbing Code of Canada.

JOB NAME:

JOB LOCATION:

CONTRACTOR:

DATE:

ENGINEER APPROVAL:

DATE:

ITEM TAG:

PART NUMBER:

Stainless Steel Sinks



Part #	Model #	Description (Size)	MAKE SELECTION BELOW
DOUBLE BOWL L CHANNEL SINK (33" x 22" x 8")			
-	HPT33223820	20 GAUGE 3 HOLE	<input type="checkbox"/>
-	HPT33224820	20 GAUGE 4 HOLE	<input type="checkbox"/>

Installation Type: Drop In

Material: 304 Stainless Steel

Gauge: 20

Number of Bowls: 2

Sink Dimensions: 33" x 22" x 8"

Drain Location: Center

Cutout Template: 3 HOLE | 4 HOLE

Cutout Dimension: N/A

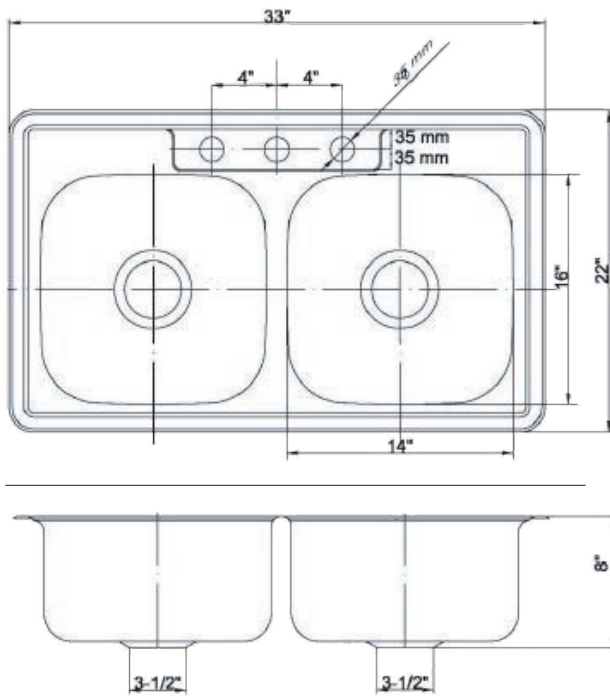

ADDITIONAL STAINLESS STEEL SINK DETAILS & INFORMATION

- One piece drawing, no welding and no center seam
- 304 Stainless Steel
- Meets UPC standards
- Sound deadening pads

JOB NAME:

JOB LOCATION:

CONTRACTOR:

DATE:

ENGINEER APPROVAL:

DATE:

ITEM TAG:

PART NUMBER:



Sinks are listed by IAPMO® as meeting the applicable requirements of the Uniform Plumbing Code®, International Plumbing Code®, and National Plumbing Code of Canada.

Stainless Steel Sinks



Part #	Model #	Description (Size)	MAKE SELECTION BELOW
DOUBLE BOWL L CHANNEL SINK (33" x 22" x 6")			
-	HPT33223624	23 GAUGE 3 HOLE	<input type="checkbox"/>
-	HPT33224624	23 GAUGE 4 HOLE	<input type="checkbox"/>

Installation Type: Drop In

Material: 304 Stainless Steel

Gauge: 23

Number of Bowls: 2

Sink Dimensions: 33" x 22" x 8"

Drain Location: Center

Cutout Template: 3 HOLE | 4 HOLE

Cutout Dimension: N/A

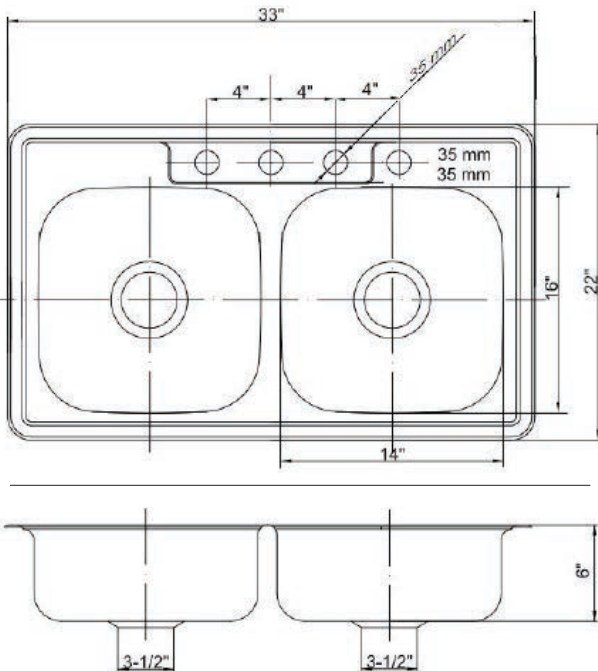

ADDITIONAL STAINLESS STEEL SINK DETAILS & INFORMATION

- One piece drawing, no welding and no center seam
- 304 Stainless Steel
- Meets UPC standards
- Sound deadening pads

JOB NAME:

JOB LOCATION:

CONTRACTOR:

DATE:

ENGINEER APPROVAL:

DATE:

ITEM TAG:

PART NUMBER:



Sinks are listed by IAPMO® as meeting the applicable requirements of the Uniform Plumbing Code®, International Plumbing Code®, and National Plumbing Code of Canada.

Stainless Steel Sinks



Part #	Model #	Description (Size)	MAKE SELECTION BELOW
SINGLE BOWL UNDERMOUNT SINK (31 1/2" x 18" x 9")			
-	SSSUSB31189	18 GAUGE UNDERMOUNT	<input type="checkbox"/>

Installation Type: Undermount

Material: 304 Stainless Steel

Gauge: 18

Number of Bowls: 1

Sink Dimensions: 31 1/2" x 18" x 9"

Drain Location: Center

Cutout Template: N/A

Cutout Dimension: N/A

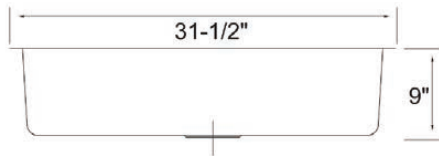

ADDITIONAL STAINLESS STEEL SINK DETAILS & INFORMATION

- One piece drawing, no welding and no center seam
- 304 Stainless Steel
- Meets UPC standards
- Sound deadening pads

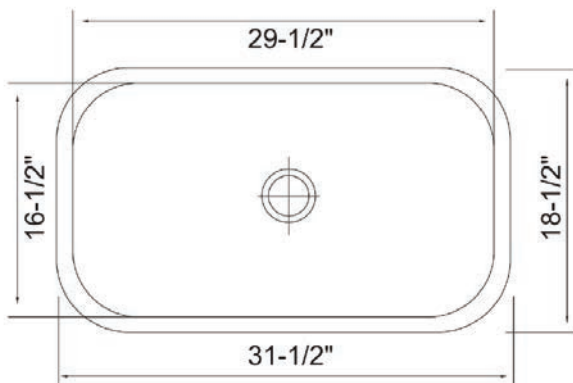

JOB NAME:

JOB LOCATION:

CONTRACTOR:

DATE:

ENGINEER APPROVAL:

DATE:

ITEM TAG:

PART NUMBER:



Sinks are listed by IAPMO® as meeting the applicable requirements of the Uniform Plumbing Code®, International Plumbing Code®, and National Plumbing Code of Canada.

Stainless Steel Sinks



Part #	Model #	Description (Size)	MAKE SELECTION BELOW
SINGLE BOWL UNDERMOUNT SINK (23" x 17 3/4" x 9")			
-	VS2318	22 GAUGE UNDERMOUNT	<input type="checkbox"/>

Installation Type: Undermount

Material: 304 Stainless Steel

Gauge: 22

Number of Bowls: 1

Sink Dimensions: 23" x 17 3/4" x 9"

Drain Location: Center

Cutout Template: N/A

Cutout Dimension: N/A

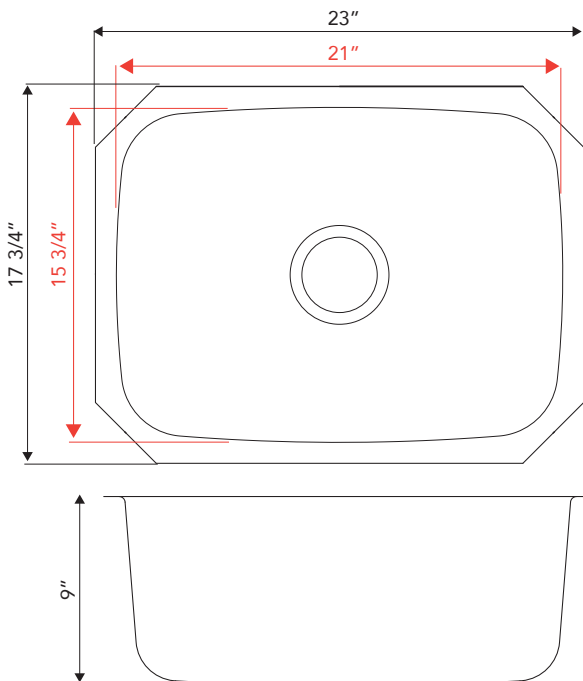

ADDITIONAL STAINLESS STEEL SINK DETAILS & INFORMATION

- One piece drawing, no welding and no center seam
- 304 Stainless Steel
- Meets UPC standards
- Sound deadening pads

JOB NAME:

JOB LOCATION:

CONTRACTOR:

DATE:

ENGINEER APPROVAL:

DATE:

ITEM TAG:

PART NUMBER:



Sinks are listed by IAPMO® as meeting the applicable requirements of the Uniform Plumbing Code®, International Plumbing Code®, and National Plumbing Code of Canada.